



Copley Close, W7

£240,000

A well-proportioned one bedroom first floor flat, located within walking distance to a range of transport links. The flat has a separate kitchen, a decent amount of storage and is offered to the market with no onward chain.

Situated close to Castlebar Park station and less than a mile from both Hanwell (Elizabeth line) and West Ealing (Elizabeth line) stations. There are also multiple bus routes to Ealing nearby.

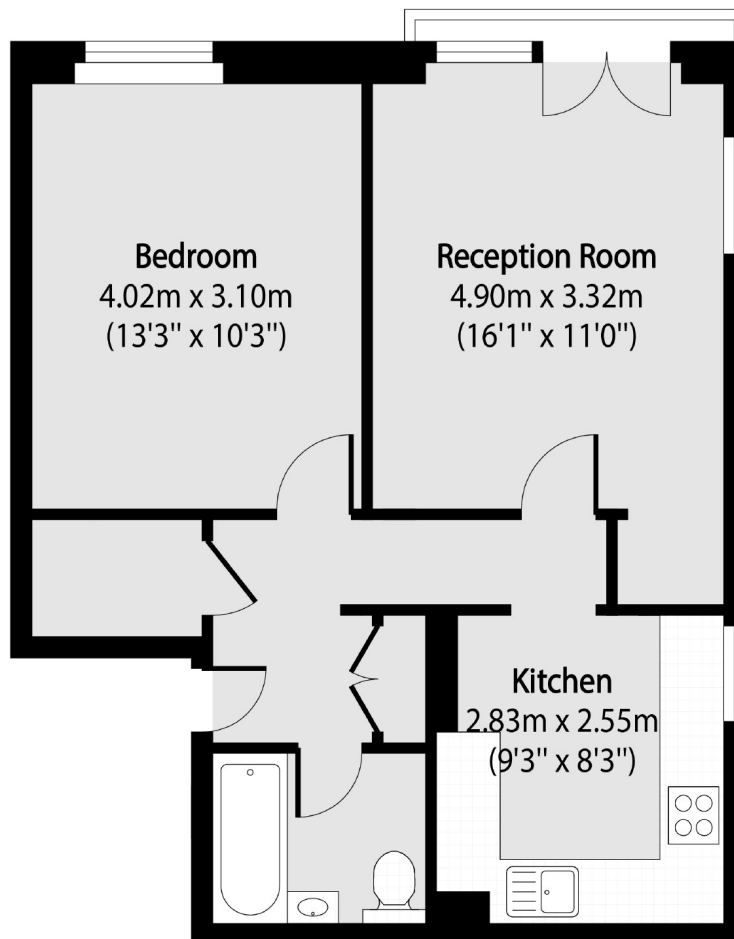

Total area (approx): 47.24 sq m (508 sq. ft)

Robertson Smith & Kempson Hanwell Sales
69 Greenford Avenue,
London, W7 1LL
020 8566 2339
hanwellsales@robertsonsmithandkempson.co.uk

Energy Rating: C. We aim to make our particulars both accurate and reliable. However they are not guaranteed; nor do they form part of an offer or contract. If you require clarification on any points then please contact us, especially if you're traveling some distance to view. Please note that appliances and heating systems have not been tested and therefore no warranties can be given as to their good working order.