



## **Camborne Avenue, W13**

**£495,000**

One of the finest garden flats in Northfields, this beautifully presented one bedroom flat is finished to an exceptional standard and comes with a share of the freehold.

Ideally located within easy reach of the Elizabeth and Piccadilly lines, this impressive flat is offered to the market chain free.



The property features a spacious double bedroom, a stunning open plan kitchen/living area perfect for modern living, and a private garden.

Ideally located for excellent transport options including West Ealing station (Elizabeth Line) & Northfields station (Piccadilly). Local parks to enjoy are Lammas, Walpole & Elthorne. A range of shops & restaurants along Northfields Avenue to choose from.

- No Onward Chain • Private Garden • Ground Floor Flat •
  - Good Transport Links • Local Parks • Shops & Restaurants •
-





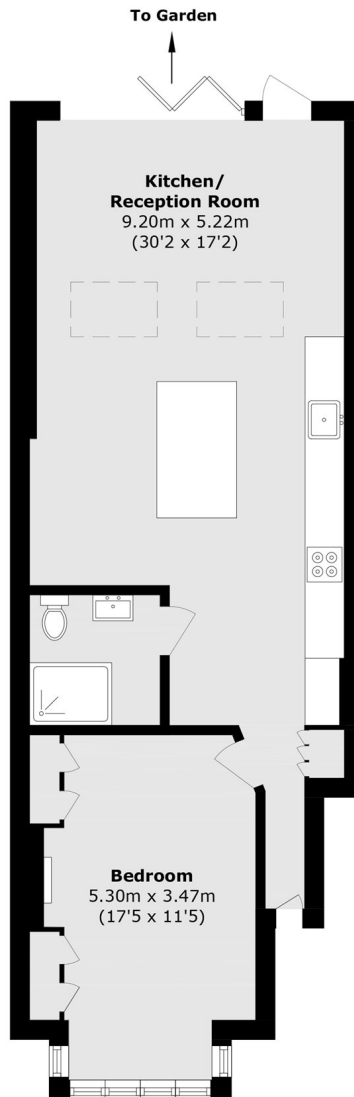

Total area (approx.): 65.2 sq. m (701.8 sq. ft)

Robertson Smith & Kempson Northfields Sales  
116 Northfield Avenue,  
London, W13 9RT  
020 8566 2340  
[northfieldssales@robertsonsmithandkempson.co.uk](mailto:northfieldssales@robertsonsmithandkempson.co.uk)

Energy Rating: C. We aim to make our particulars both accurate and reliable. However they are not guaranteed; nor do they form part of an offer or contract. If you require clarification on any points then please contact us, especially if you're traveling some distance to view. Please note that appliances and heating systems have not been tested and therefore no warranties can be given as to their good working order.