



Churchfield Road, W13

£425,000

* OFFERS IN EXCESS OF*

A spacious two bedroom flat with excellent ceiling height, an open plan kitchen, a well sized bathroom, and a generous living area. The property also benefits from access to a communal garden.



This apartment enjoys wonderful natural light, a spacious open plan kitchen, and a generous reception room with high ceilings and attractive period features. It offers two well proportioned double bedrooms, a family bathroom, and access to a communal shared garden.

Ideally located for Elizabeth Line (West Ealing) and Piccadilly (Northfields) providing excellent transport links to London. A selection of wonderful parks on your doorstep including Walpole & Lammas.

- Share of Freehold • Elizabeth Line (West Ealing) • Communal Garden •
 - Large Double Bedroom • High Period Ceilings • Natural Light Throughout •
-



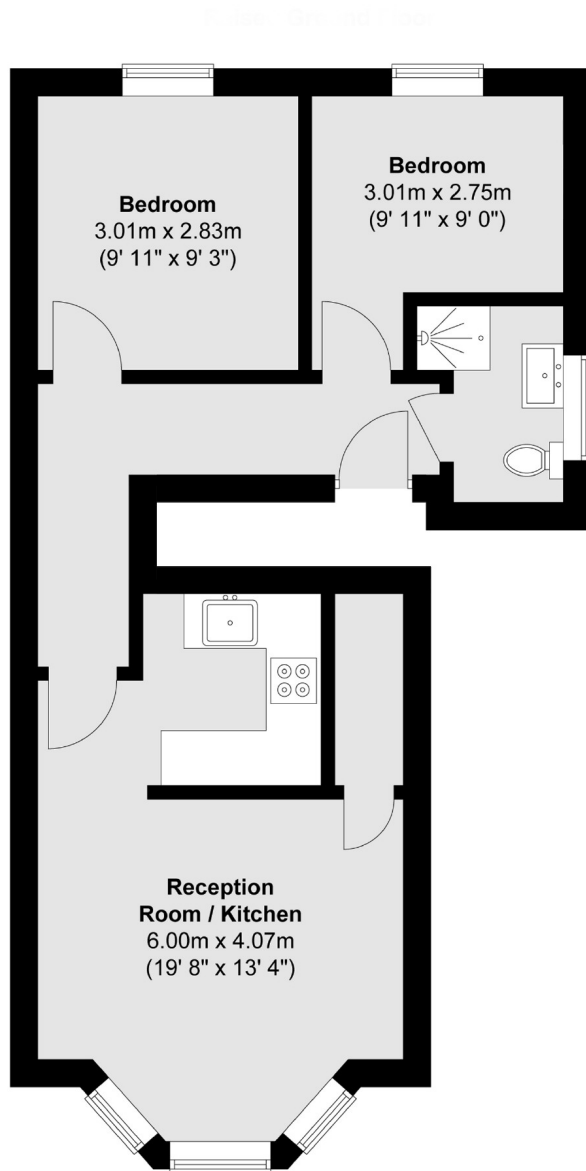

Total area (approx.) : 47.8 sq. m (514 sq. ft)

Robertson Smith & Kempson Northfields Sales
116 Northfield Avenue,
London, W13 9RT
020 8566 2340
northfieldssales@robertsonsmithandkempson.co.uk

Energy Rating: D. We aim to make our particulars both accurate and reliable. However they are not guaranteed; nor do they form part of an offer or contract. If you require clarification on any points then please contact us, especially if you're traveling some distance to view. Please note that appliances and heating systems have not been tested and therefore no warranties can be given as to their good working order.