



Dudley Gardens, W13

£925,000

A beautiful three bedroom family home with huge potential to extend the property further (STPP) and attractively offered onto the market with no onward chain.



A spacious family home, the ground floor offers two reception rooms, and kitchen which leads to the secluded garden. The first floor accommodation comprises three double bedrooms and family bathroom. Potential to extend to the rear & loft like many neighbouring properties have done (STPP).

Ideally located for some amazing parks including Lammas & Walpole. Well regarded schools to choose from locally. Excellent transport links including Northfields station (Piccadilly) & West Ealing station (Elizabeth Line).

- Three Bedroom • No Onward Chain • Secluded Garden •
 - Local Parks • Well Regarded Schools • Excellent Transport Links •
-



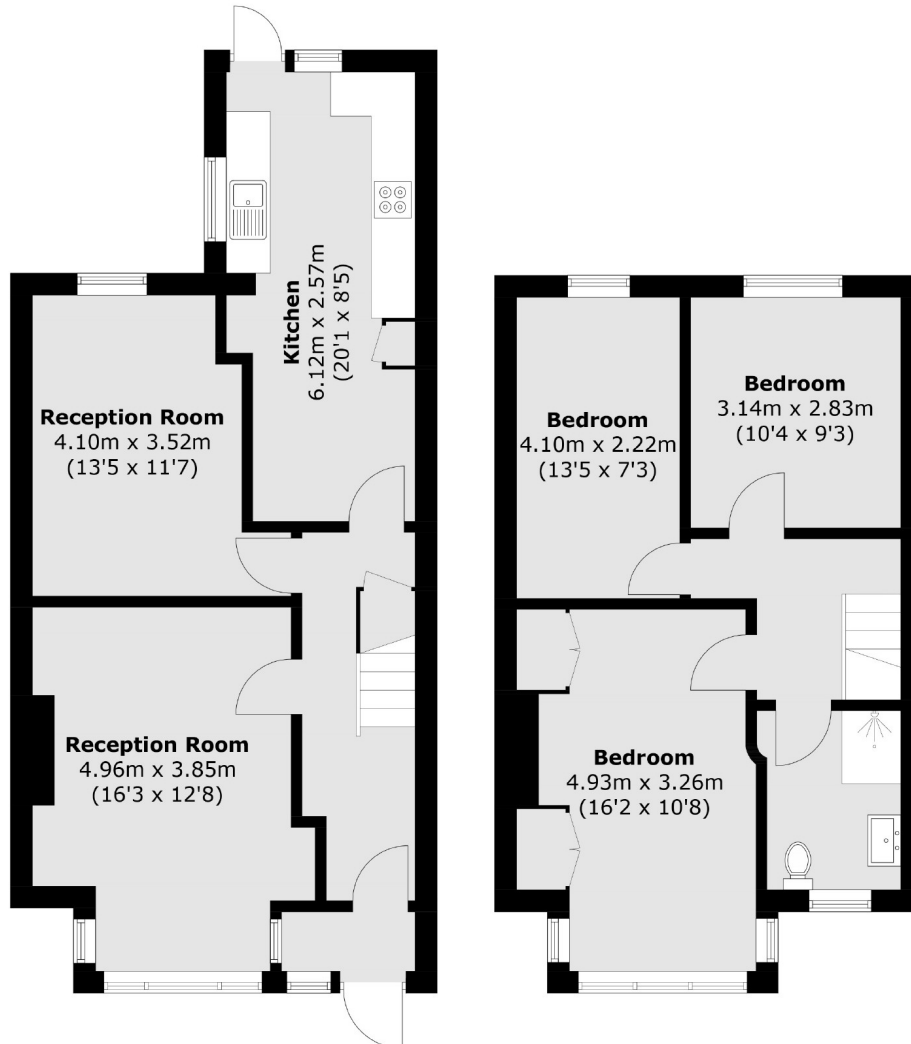

Ground Floor

First Floor

Total area (approx.): 100.0 sq. m (1,076.4 sq. ft)

Robertson Smith & Kempson Northfields Sales
 116 Northfield Avenue,
 London, W13 9RT
 020 8566 2340
northfieldssales@robertsonsmithandkempson.co.uk

Energy Rating: . We aim to make our particulars both accurate and reliable. However they are not guaranteed; nor do they form part of an offer or contract. If you require clarification on any points then please contact us, especially if you're traveling some distance to view. Please note that appliances and heating systems have not been tested and therefore no warranties can be given as to their good working order.