



Northfield Avenue, W13

£600,000

A beautifully presented two double bedroom apartment set within a secure gated development. This spacious home features a generous reception room that opens directly onto a private, secluded garden and offered chain free.

Bonneville House is conveniently located for West Ealing mainline station, Northfields (Piccadilly Line) tube and the many amenities on Northfield Avenue.

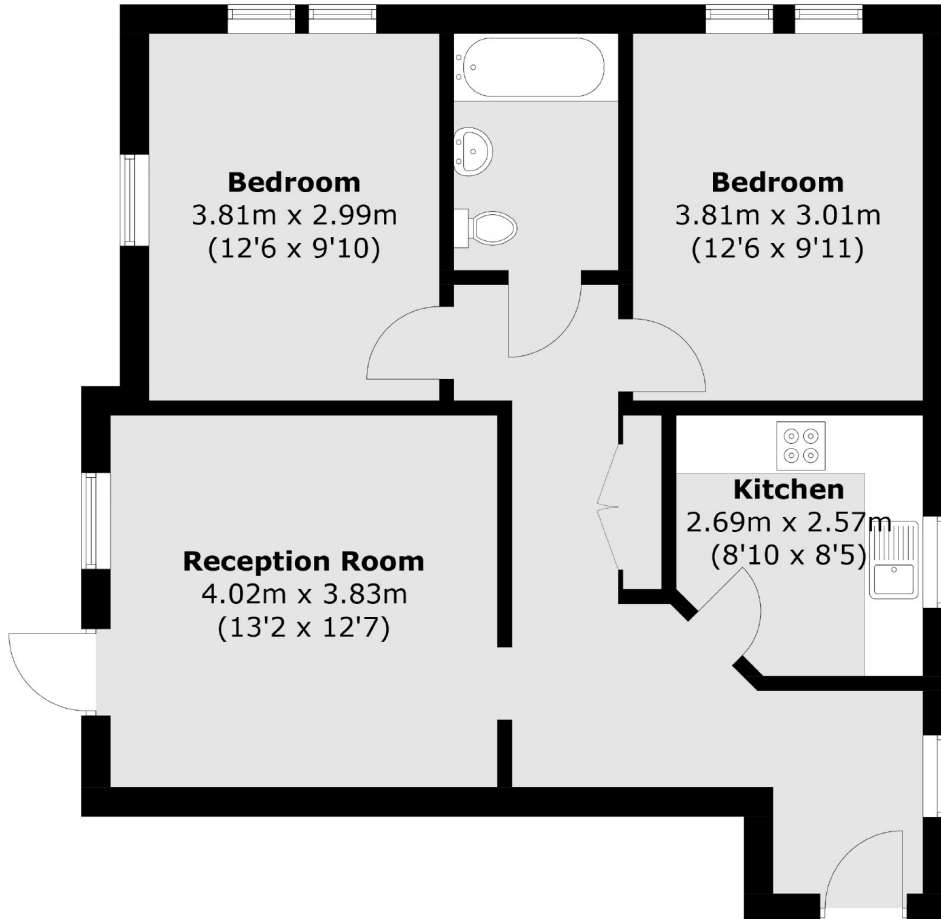

Ground Floor

Total area (approx.): 65.9 sq. m (709.3 sq. ft)

Robertson Smith & Kempson Northfields Sales
116 Northfield Avenue,
London, W13 9RT
020 8566 2340
northfieldssales@robertsonsmithandkempson.co.uk

Energy Rating: . We aim to make our particulars both accurate and reliable. However they are not guaranteed; nor do they form part of an offer or contract. If you require clarification on any points then please contact us, especially if you're traveling some distance to view. Please note that appliances and heating systems have not been tested and therefore no warranties can be given as to their good working order.