



Leighton Road, W13

£775,000

A beautiful three bedroom family home with a secluded garden and huge potential to extend (STPP). Perfectly located for Ofsted outstanding schools, many excellent transport links and a choice of local parks.



Presented in excellent condition throughout and filled with natural light, the ground floor accommodation comprises a large front reception room and kitchen with utility off it. Three bedrooms and a brand new family bathroom on the first floor.

Ideally located for Ofsted outstanding schools including Oaklands, Fielding & Elthorne High. West Ealing (Elizabeth Line) and Northfields station (Piccadilly) both within walking distance providing excellent transport links.

- Three Bedrooms • Secluded Garden • Excellent Transport Links •
 - Local Parks • Ofsted Outstanding Schools • Beautiful Condition •
-



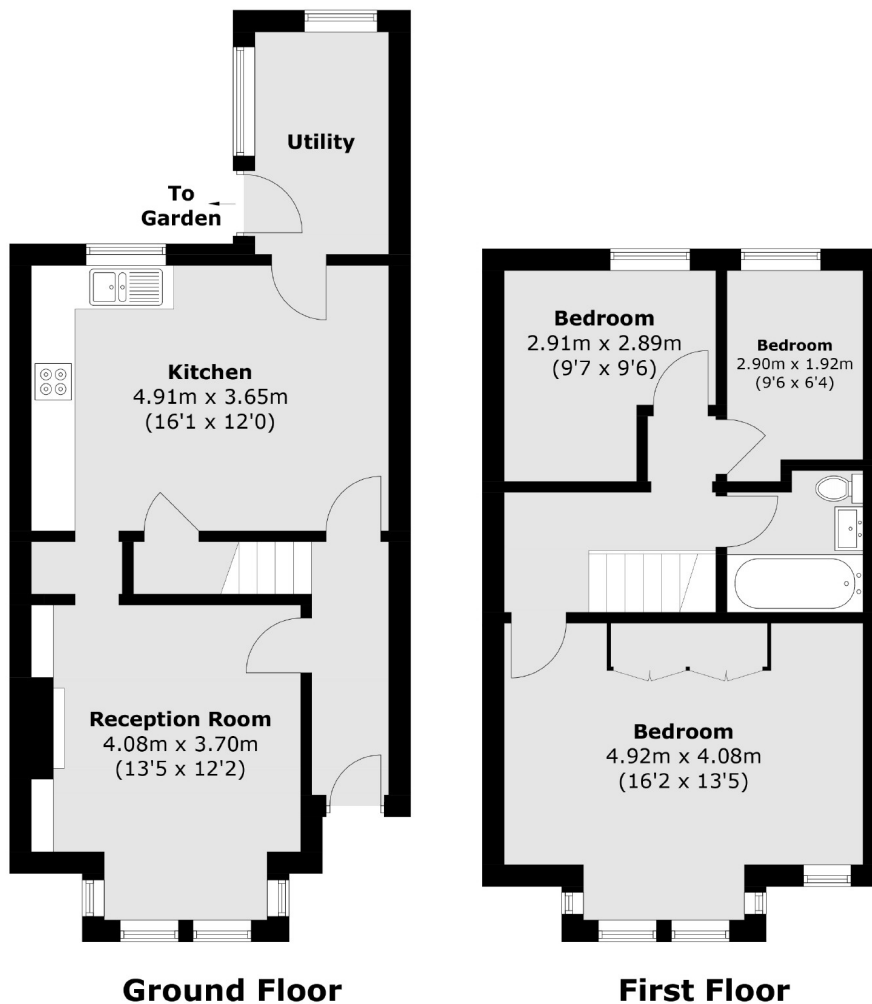

Total area (approx.): 88.8 sq. m (955.8 sq. ft)

Robertson Smith & Kempson Northfields Sales
116 Northfield Avenue,
London, W13 9RT
020 8566 2340
northfieldssales@robertsonsmithandkempson.co.uk

Energy Rating: D. We aim to make our particulars both accurate and reliable. However they are not guaranteed; nor do they form part of an offer or contract. If you require clarification on any points then please contact us, especially if you're traveling some distance to view. Please note that appliances and heating systems have not been tested and therefore no warranties can be given as to their good working order.