



Hessel Road, W13

£1,045,000

A most unique and rare house within it's location, a six bedroom detached house on Hessel Road (55A). With a buyers touch, it could be the most amazing family home. Viewings available now!

Ideally located for West Ealing (Elizabeth Line) and Northfields station (Piccadilly). Local parks to enjoy including Elthorne, Lammas & Walpole. Well regarded schools including the Ofsted outstanding Fielding primary & Elthorne High.

- No Onward Chain • Detached • Six Bedrooms •
- Elizabeth Line (Crossrail) • Secluded Garden • Fielding School (Ofsted) •

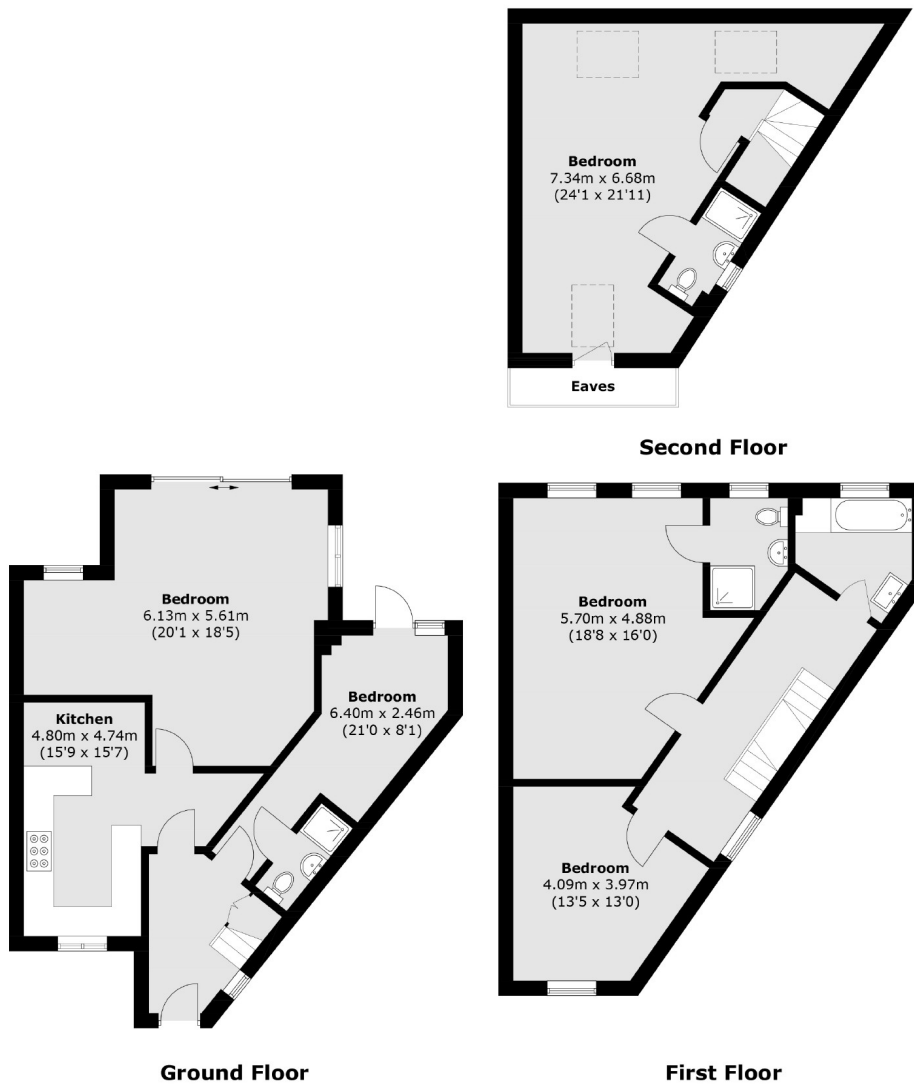

Total area (approx.): 152.8 sq. m (1,644.7 sq. ft)
(Excluding Eaves)

Robertson Smith & Kempson Northfields Sales
116 Northfield Avenue,
London, W13 9RT
020 8566 2340
northfieldssales@robertsonsmithandkempson.co.uk

Energy Rating: . We aim to make our particulars both accurate and reliable. However they are not guaranteed; nor do they form part of an offer or contract. If you require clarification on any points then please contact us, especially if you're traveling some distance to view. Please note that appliances and heating systems have not been tested and therefore no warranties can be given as to their good working order.