



## Erlesmere Gardens, W13

£925,000

A simply superb three bedroom family home set in Ofsted outstanding school catchments with a large south facing secluded garden. Potential to extend into the loft (STPP).



Offering nearly 1200 sq ft, this beautiful family home is a must for early viewing. On the ground floor, the accommodation offers a large front reception room, WC & extended kitchen/diner leading to the secluded south-facing garden. The first floor comprises of two double bedrooms, additional single bedroom and family bathroom.

Ideally located for a range of transport options including Northfields & Boston Manor station (Piccadilly). West Ealing station also provides excellent access to London via the Elizabeth Line. Local parks including Elthorne, Lammas & Walpole. Ofsted outstanding schools including Fielding & Elthorne High.

- Three Bedroom • Secluded South-Facing Garden • Ofsted Schools •
  - Local Parks • Excellent Transport Links • Shops & Restaurants •
-



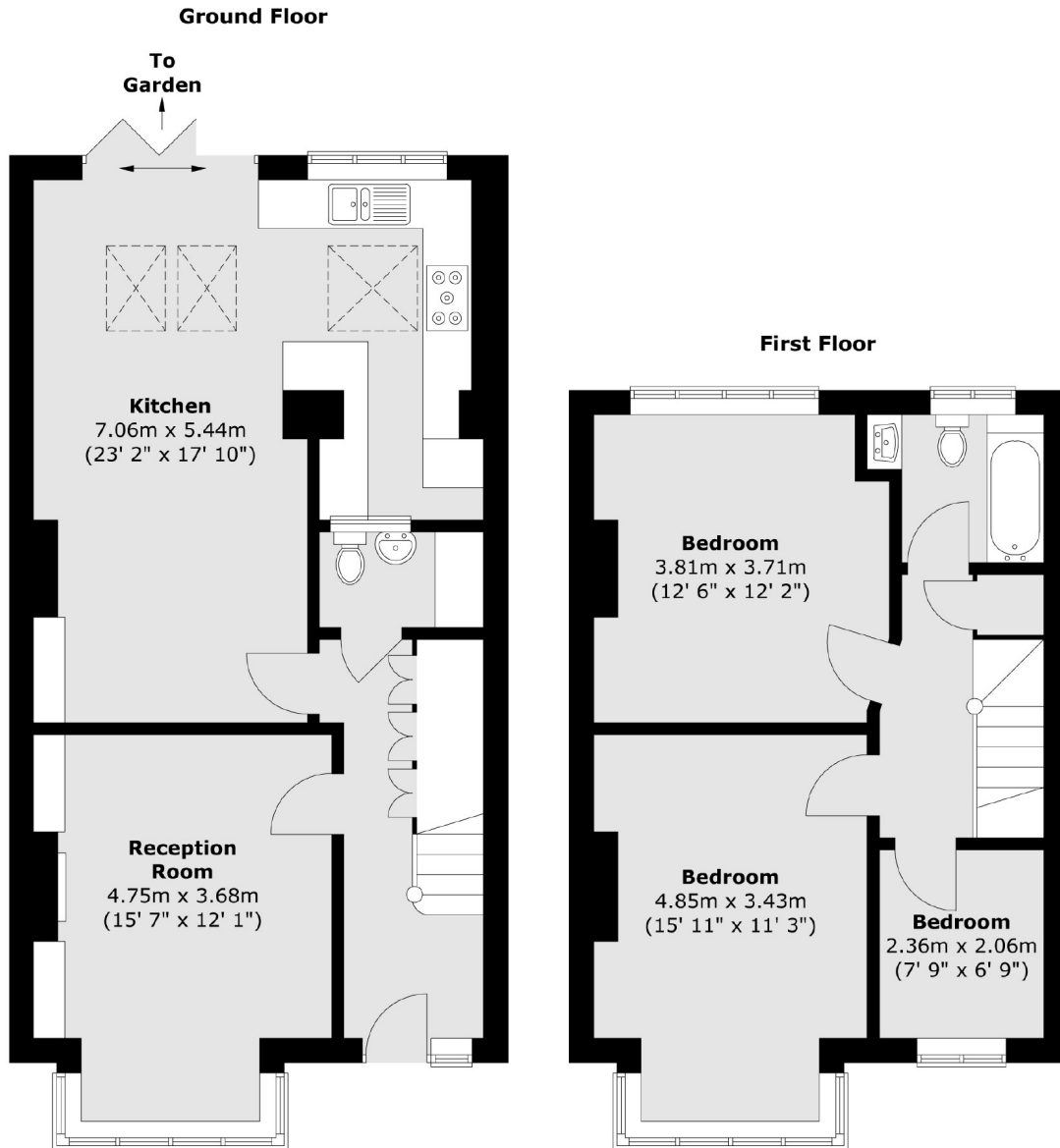

Total area (approx.) : 109.6 sq. m (1180 sq. ft)

Robertson Smith & Kempson Northfields Sales  
116 Northfield Avenue,  
London, W13 9RT  
020 8566 2340  
[northfieldssales@robertsonsmithandkempson.co.uk](mailto:northfieldssales@robertsonsmithandkempson.co.uk)

Energy Rating: . We aim to make our particulars both accurate and reliable. However they are not guaranteed; nor do they form part of an offer or contract. If you require clarification on any points then please contact us, especially if you're traveling some distance to view. Please note that appliances and heating systems have not been tested and therefore no warranties can be given as to their good working order.