



Westfield Road, W13

£475,000

A beautifully presented well proportioned two double bedroom ground floor flat with private landscaped rear garden (currently all open but could be divided). Attractively offered to the market with a long lease.



This stunning maisonette must be seen to be truly appreciated, comprising large reception room filled with natural light and period features, principal double bedroom, kitchen with breakfast bar, family bathroom and additional double bedroom. An abundance of storage throughout.

Ideally located for West Ealing station (Crossrail) and many parks locally including Elthorne Park, Walpole Park & Lammas Park providing excellent family amenities.

- Two Double Bedroom • Ground Floor Flat • Long Lease •
- Beautiful Condition • Excellent Transport Links • Shared Garden •



Ground Floor

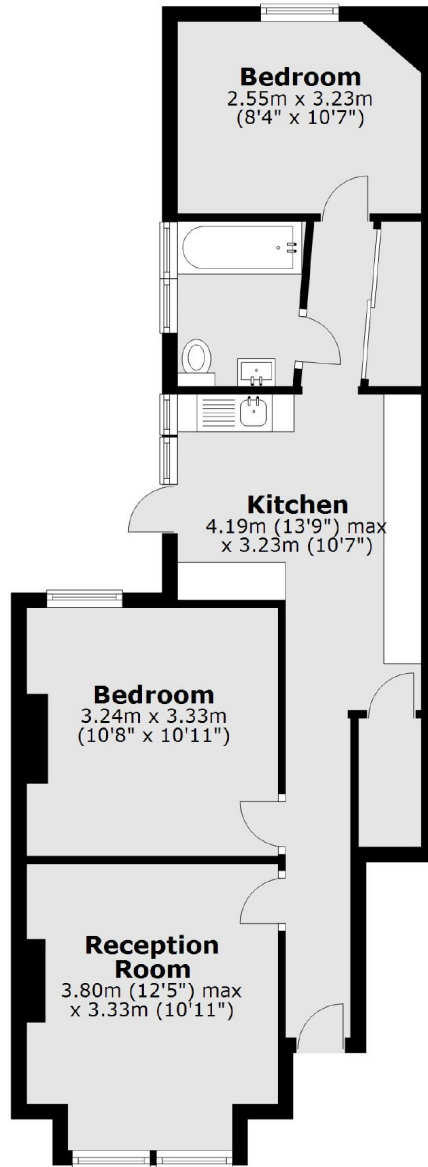

Total area: approx. 57.1 sq. metres (615.0 sq. feet)

Robertson Smith & Kempson Northfields Sales
116 Northfield Avenue,
London, W13 9RT
020 8566 2340
northfieldssales@robertsonsmithandkempson.co.uk

Energy Rating: C. We aim to make our particulars both accurate and reliable. However they are not guaranteed; nor do they form part of an offer or contract. If you require clarification on any points then please contact us, especially if you're traveling some distance to view. Please note that appliances and heating systems have not been tested and therefore no warranties can be given as to their good working order.