



## Hanger Lane, W5

£426 pw (£1,850 pcm)

A well-maintained two bedroom flat offers a spacious and reception room, separate fully fitted kitchen and two bathrooms (one en suite) . The property also features wooden flooring as well as a private balcony.

Greystoke Court is a stunning Art Deco mansion block situated on Hanger Hill and offering magnificent easterly views along the A40 corridor and five minutes walk to Hanger Lane station.

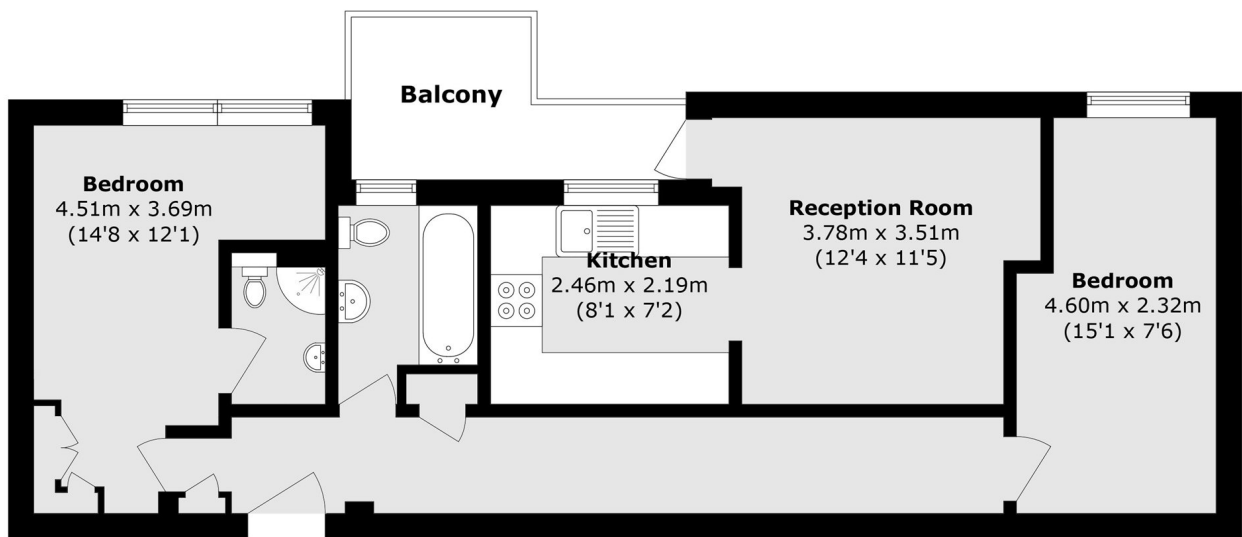

Total area (approx.): 58.9 sq. m (633.9 sq. ft)

Balcony area (approx.): 5.5 sq. m (18'0 sq. ft)

Robertson Smith & Kempson Ealing Lettings  
1 The Broadway,  
London, W5 2NT  
020 8840 7885  
[ealinglettings@robertsonsmithandkempson.co.uk](mailto:ealinglettings@robertsonsmithandkempson.co.uk)

Energy Rating: C. We aim to make our particulars both accurate and reliable. However they are not guaranteed; nor do they form part of an offer or contract. If you require clarification on any points then please contact us, especially if you're traveling some distance to view. Please note that appliances and heating systems have not been tested and therefore no warranties can be given as to their good working order.