



St. Marys Square, W5

£799,950

This stunning two bedroom home is finished to an exceptional standard throughout and is offered to the market chain free. Thoughtfully designed and beautifully presented, it combines modern elegance with practical living, making it a perfect choice for professionals, couples, or families.



Immaculately presented throughout, the ground floor comprises a spacious reception room, WC, and a stylish open plan kitchen. The first floor boasts two generous double bedrooms, a spacious walk-in-wardrobe and a modern family bathroom.

St Mary's Square is ideally located for easy access to the shops and amenities of Ealing, as well as Ealing Broadway Station (Central and Elizabeth lines) and South Ealing Tube Station (Piccadilly line).

- No Onward Chain • Secluded Garden • Two Bedrooms •
- Underfloor Heating • Excellent Condition • Walk-In-Wardrobe •



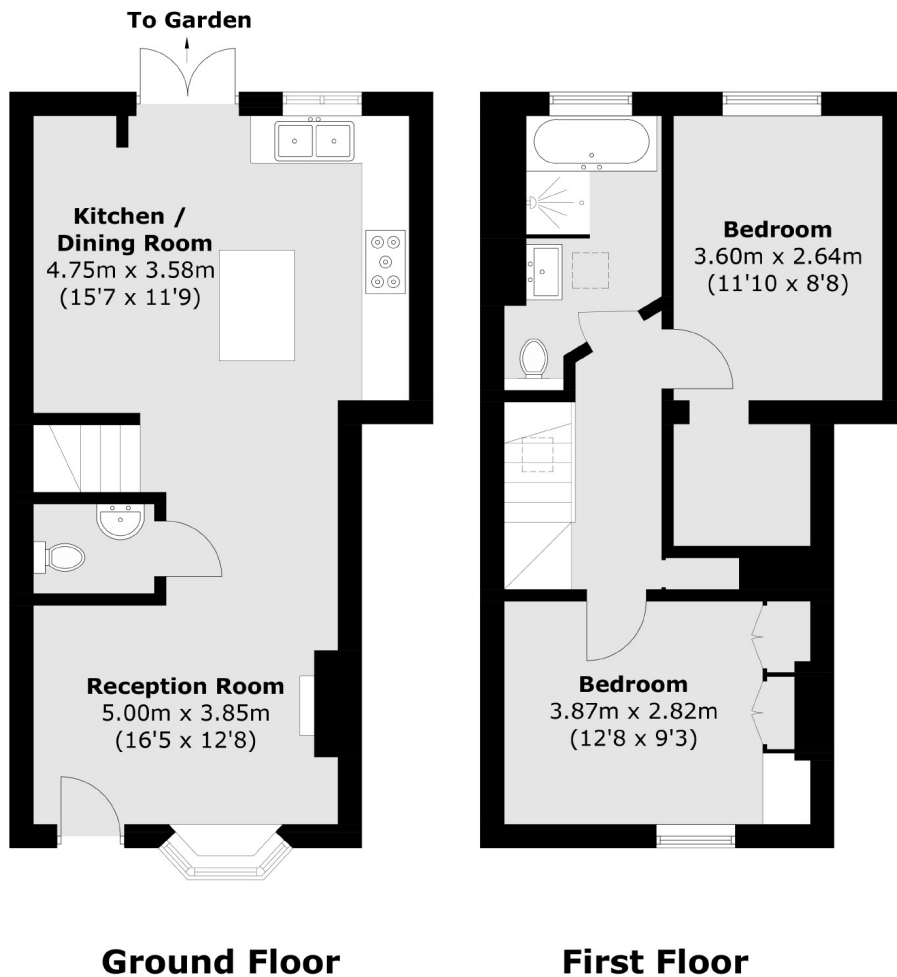

Total area (approx.): 75.9 sq. m (816.9 sq. ft)

Robertson Smith & Kempson Ealing Sales
 1 The Broadway, London,
 W5 2NT
 020 8840 7677
ealingsales@robertsonsmithandkempson.co.uk

Energy Rating: D. We aim to make our particulars both accurate and reliable. However they are not guaranteed; nor do they form part of an offer or contract. If you require clarification on any points then please contact us, especially if you're traveling some distance to view. Please note that appliances and heating systems have not been tested and therefore no warranties can be given as to their good working order.