



## **Corfton Road, W5**

**£530 pw (£2,300 pcm)**

This recently refurbished property features two spacious double bedrooms, a large living room, separate kitchen and a modern bathroom. Additional benefits include an off-street parking and access to a communal gardens.

Located just a 10-minute walk from Ealing Broadway. Corfton Road is perfectly positioned near Ealing Cricket Club, offering excellent transport links and a vibrant community atmosphere.

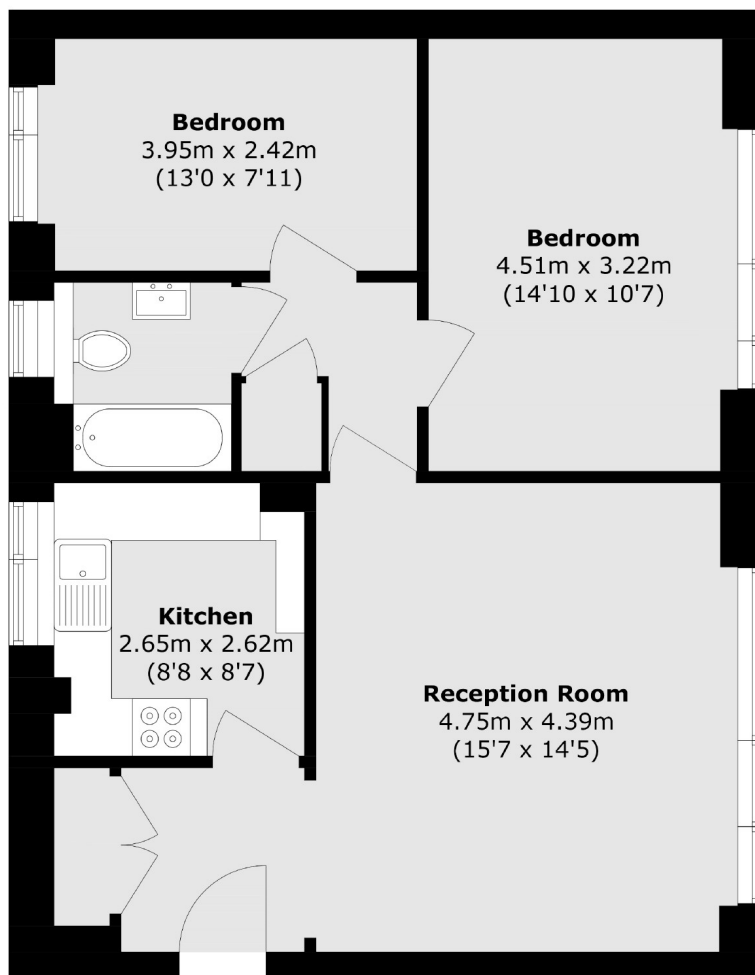

Total area (approx.): 69.4 sq. m (747.0 sq. ft)

Robertson Smith & Kempson Ealing Lettings  
1 The Broadway, London, W5  
2NT  
020 8840 7885  
[ealinglettings@robertsonsmithandkempson.co.uk](mailto:ealinglettings@robertsonsmithandkempson.co.uk)

Energy Rating: D. We aim to make our particulars both accurate and reliable. However they are not guaranteed; nor do they form part of an offer or contract. If you require clarification on any points then please contact us, especially if you're traveling some distance to view. Please note that appliances and heating systems have not been tested and therefore no warranties can be given as to their good working order.