



**New Kings Road, SW6**

**£375,000**

\*\*\* Offers over \*\*\*

Offering huge potential, a superbly located one double bedroom flat attractively offered onto the market with no onward chain and a long lease.



Nearly 500 sq ft, this large one bedroom flat provides an an opportunity for the new buyer to put their own stamp on it. The accommodation comprises a large front reception, bathroom, kitchen and double bedroom.

Ideally located for Fulham Broadway station (0.3 miles), Imperial Wharf station (0.4 miles) & Parsons Green station (0.4 miles). Eel Brook Common is a short walk away providing a fantastic family amenity.

- Long Lease • No Onward Chain • One Double Bedroom •
  - Excellent Transport Links • Eel Brook Common • Nearly 500 Sq Ft •
-





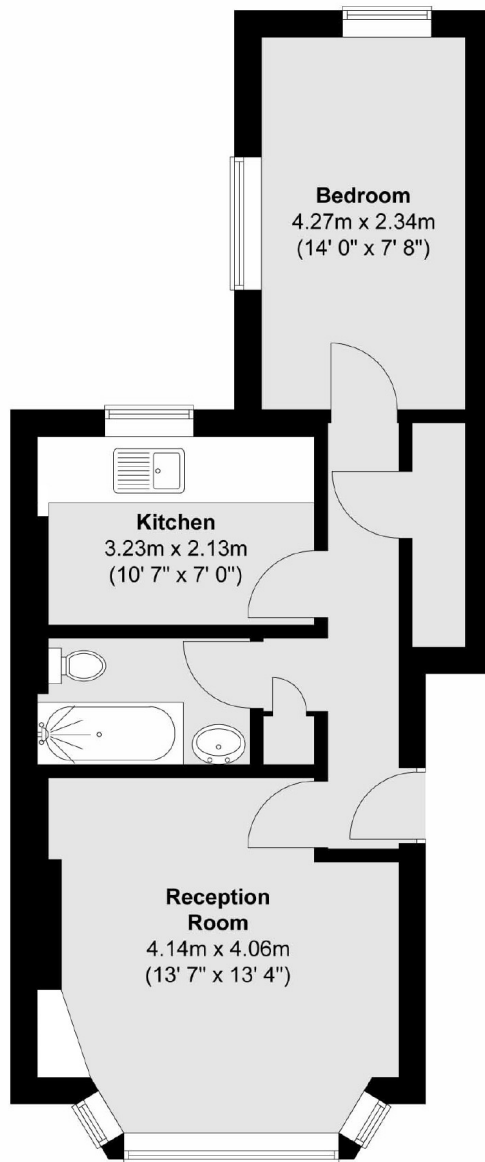

Total area (approx.) : 44.9 sq. m (483 sq. ft)

Robertson Smith & Kempson Ealing Sales  
1 The Broadway, London,  
W5 2NT  
020 8840 7677  
[ealingsales@robertsonsmithandkempson.co.uk](mailto:ealingsales@robertsonsmithandkempson.co.uk)

Energy Rating: . We aim to make our particulars both accurate and reliable. However they are not guaranteed; nor do they form part of an offer or contract. If you require clarification on any points then please contact us, especially if you're traveling some distance to view. Please note that appliances and heating systems have not been tested and therefore no warranties can be given as to their good working order.