



Mulgrave Road, W5

£805 pw (£3,490 pcm)

This generously sized four bedroom house in a highly sought-after area of Ealing features a modern kitchen, double reception room and two bathrooms. Additional features include a garage and a well-maintained landscaped garden.

Mulgrave Road is close by green open spaces of Pitshanger Park, Ealing amenities and Hanger Lane Station.

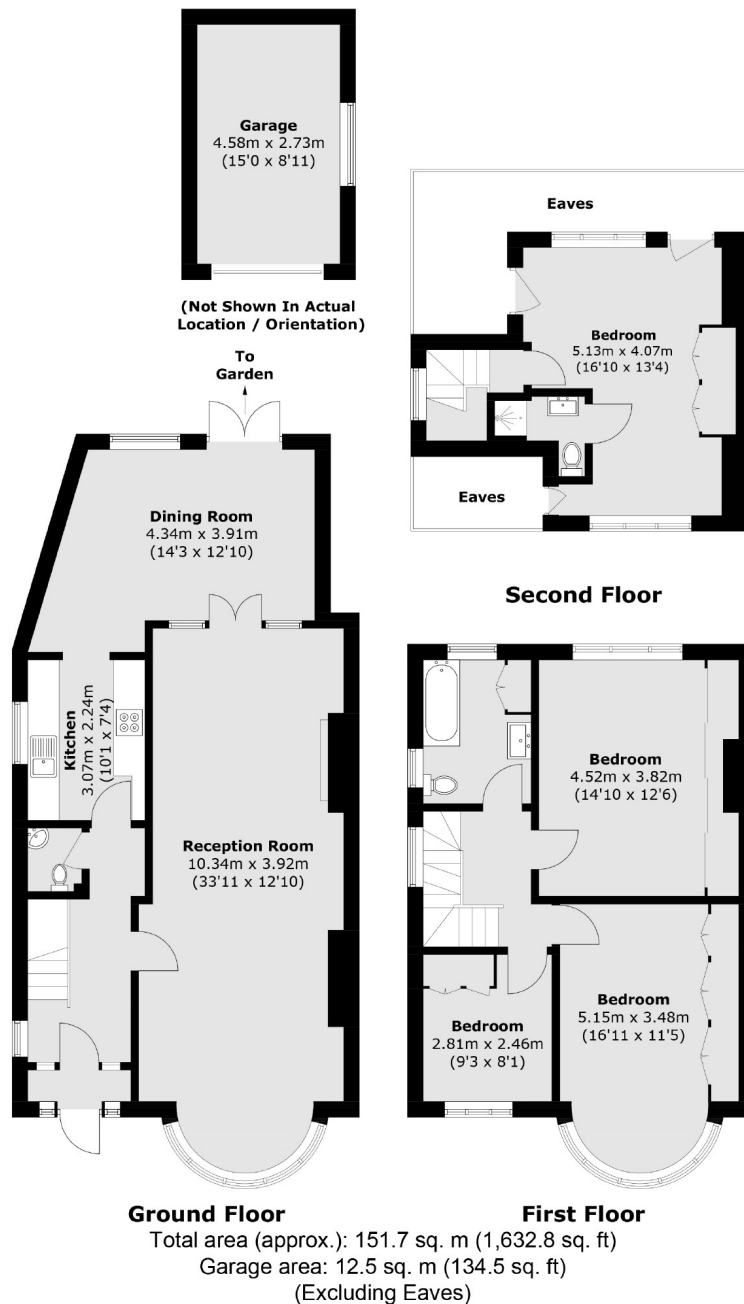

Robertson Smith & Kempson Ealing Lettings
1 The Broadway, London, W5
2NT
020 8840 7885
ealinglettings@robertsonsmithandkempson.co.uk

Energy Rating: C. We aim to make our particulars both accurate and reliable. However they are not guaranteed; nor do they form part of an offer or contract. If you require clarification on any points then please contact us, especially if you're traveling some distance to view. Please note that appliances and heating systems have not been tested and therefore no warranties can be given as to their good working order.