



Kenilworth Road, W5

£461 pw (£2,000 pcm)

This two bedroom ground floor flat features a semi-open plan fully equipped kitchen, spacious reception and modern bathroom. The property also has a private garden, double glazed windows and gas central heating.

Located on a popular tree-lined street with easy access to Ealing Broadway station (Central, District, Elizabeth lines overground). Ealing Common and Walpole Park are also close by.

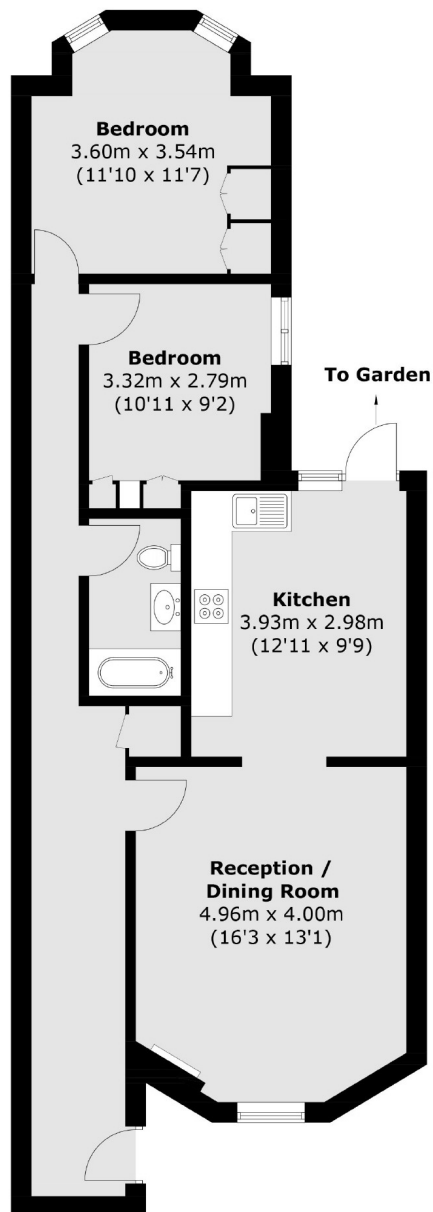

Total area (approx.): 74.0 sq. m (796.5 sq. ft)

Robertson Smith & Kempson Ealing Lettings
1 The Broadway, London, W5
2NT
020 8840 7885
ealinglettings@robertsonsmithandkempson.co.uk

Energy Rating: D. We aim to make our particulars both accurate and reliable. However they are not guaranteed; nor do they form part of an offer or contract. If you require clarification on any points then please contact us, especially if you're traveling some distance to view. Please note that appliances and heating systems have not been tested and therefore no warranties can be given as to their good working order.