



Argyle Road, W13

£450,000

Offers in excess of £475,000

High ceilings help create this spacious, bright and airy two bedroom garden flat ideally located for the Elizabeth line at West Ealing.



Beautiful character and high ceilings throughout, this flat comprises two bedrooms (one large double and an additional smaller double), family bathroom, and generous living/dining room. Including a large shared garden where the current owners have four sheds, which are ideal for storage.

Ideally located for West Ealing station (Elizabeth Line) providing excellent links to central London. Local parks include Drayton Green and Pitshanger park.

- Two Bedrooms • Shared Garden • Elizabeth Line (West Ealing) •
 - Excellent Condition • Local Parks • Long Lease •
-



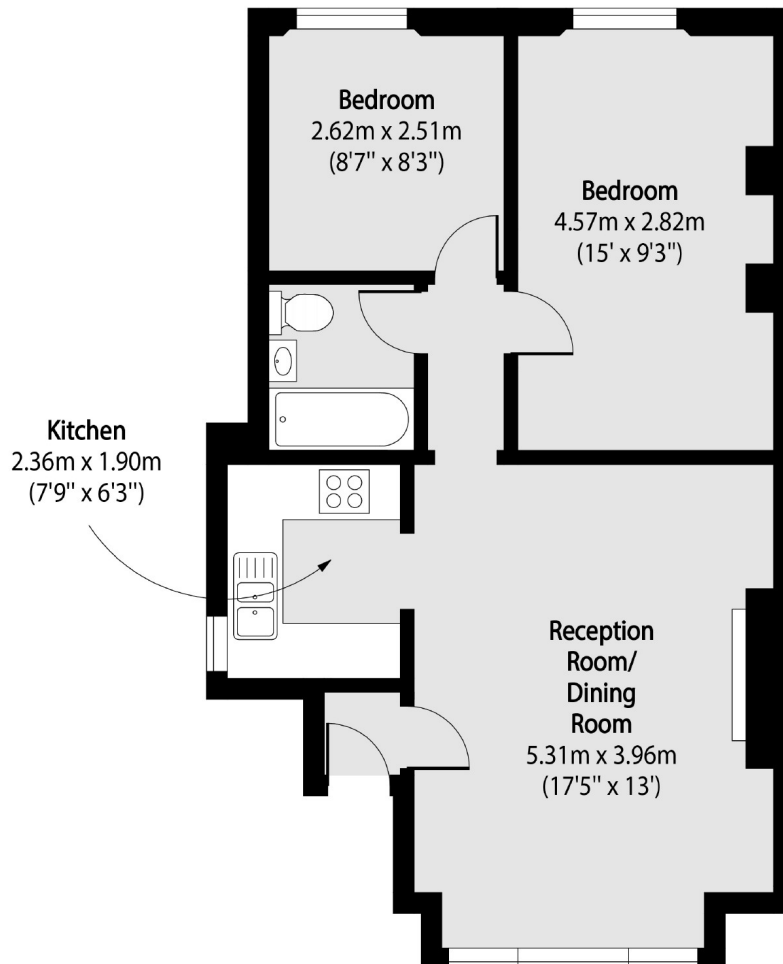

Total area (approx): 52.86 sq m (569 sq. ft)

Robertson Smith & Kempson Ealing Sales
1 The Broadway, London,
W5 2NT
020 8840 7677
ealingsales@robertsonsmithandkempson.co.uk

Energy Rating: D. We aim to make our particulars both accurate and reliable. However they are not guaranteed; nor do they form part of an offer or contract. If you require clarification on any points then please contact us, especially if you're traveling some distance to view. Please note that appliances and heating systems have not been tested and therefore no warranties can be given as to their good working order.