



Western Avenue, W5

£369 pw (£1,600 pcm)

This purpose built apartment has just been newly redecorated and has a double bedroom, large reception room, separate kitchen, modern bathroom and ample storage. The property also has an allocated parking space for one car.

Gordon House is less than half a mile from Hanger Lane station and various shops and amenities.

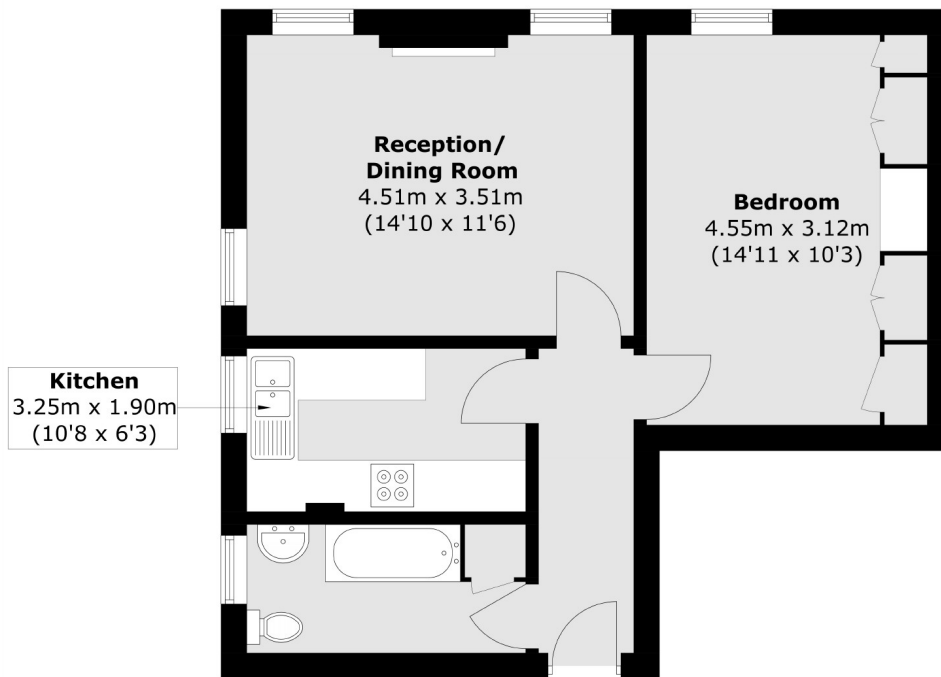

Total area (approx.): 48.2 sq. m (518.8 sq. ft)

Robertson Smith & Kempson Ealing Lettings
1 The Broadway, London, W5
2NT
020 8840 7885
ealinglettings@robertsonsmithandkempson.co.uk

Energy Rating: C. We aim to make our particulars both accurate and reliable. However they are not guaranteed; nor do they form part of an offer or contract. If you require clarification on any points then please contact us, especially if you're traveling some distance to view. Please note that appliances and heating systems have not been tested and therefore no warranties can be given as to their good working order.