



Agate Close, NW10

£646 pw (£2,800 pcm)

A modern three bedroom apartment with private balcony. The property is in excellent condition throughout, has two bathrooms and secure underground parking.

Agate Close is within half a mile of both Hanger Lane and Park Royal stations both of which provide excellent access into town.

- Three Bedrooms • Two Bathrooms • Private Balcony •
- Underground Parking • Hanger Lane • Balcony •

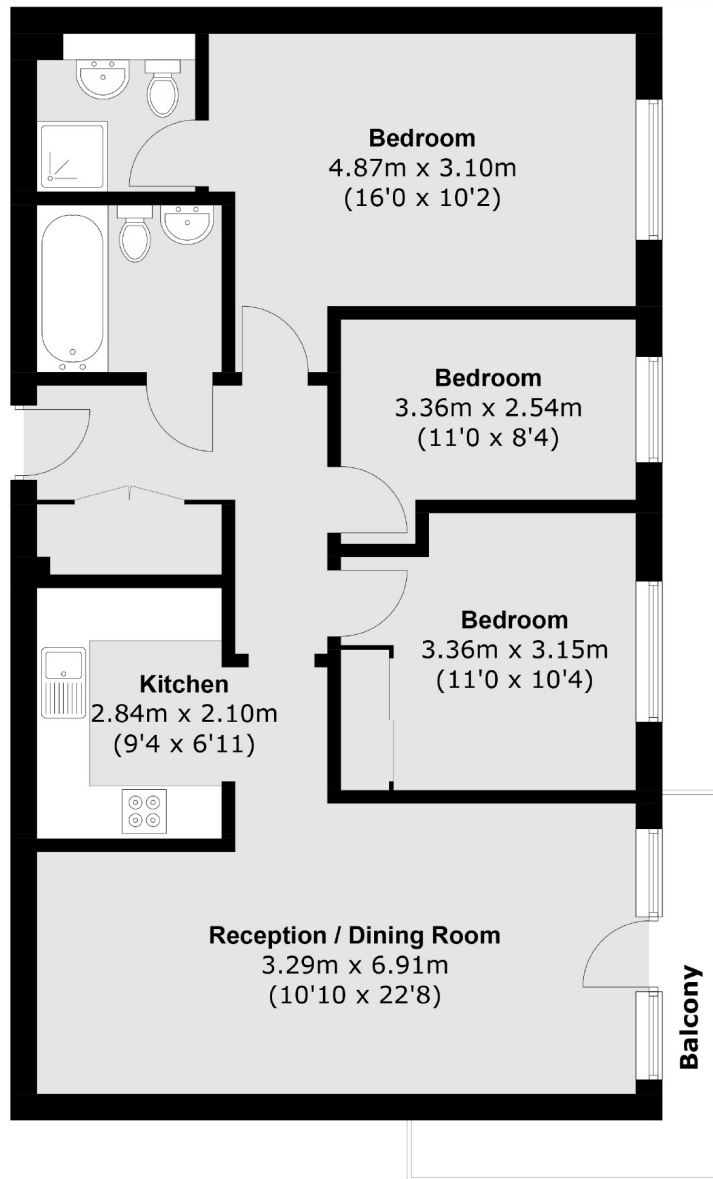

Total area (approx.): 82.2 sq. m (884.8 sq. ft)
Balcony: 4.7 sq. m (50.6 sq. ft)

Robertson Smith & Kempson Ealing Lettings
1 The Broadway, London, W5
2NT
020 8840 7885
ealinglettings@robertsonsmithandkempson.co.uk

Energy Rating: C. We aim to make our particulars both accurate and reliable. However they are not guaranteed; nor do they form part of an offer or contract. If you require clarification on any points then please contact us, especially if you're traveling some distance to view. Please note that appliances and heating systems have not been tested and therefore no warranties can be given as to their good working order.