



## Cecil Close, W5

£761 pw (£3,300 pcm)

This first floor flat has been refurbished to a high standard. The is a large open plan kitchen, living, dining room, three bedrooms and a family bathroom. The property also has wooden flooring throughout, integrated appliances in the kitchen, ample of storage throughout and also has hot water and heating is included.

Situated on one of Ealing's premier locations and next to the

## Ground Floor

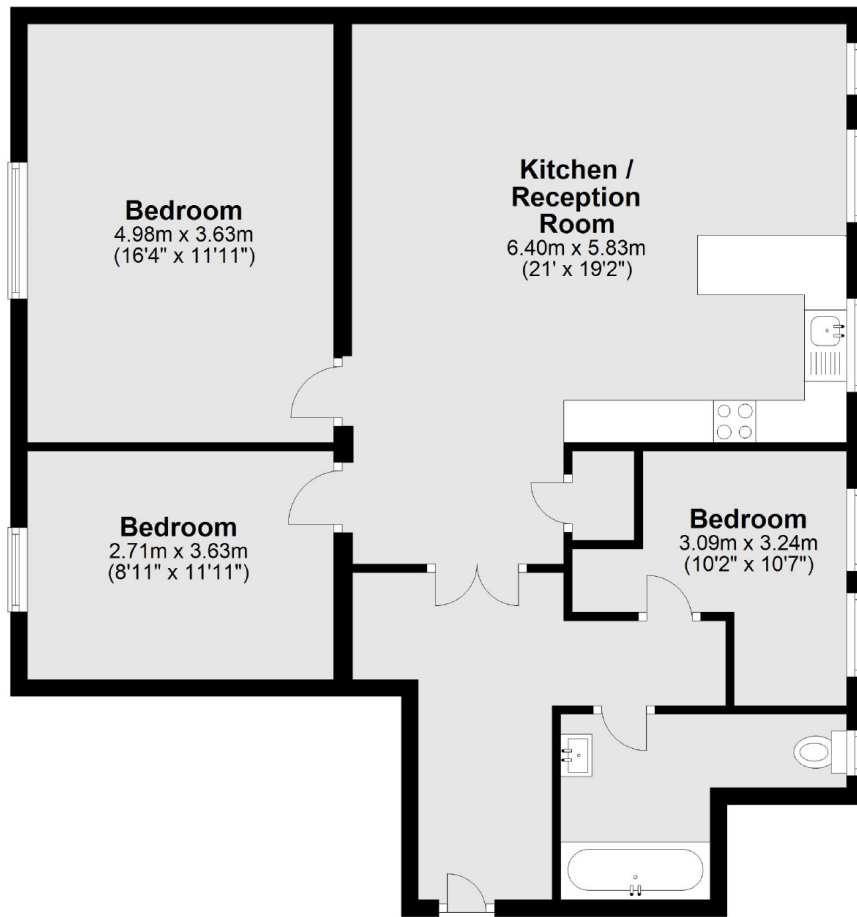

Total area: approx. 86.6 sq. metres (931.6 sq. feet)

Robertson Smith & Kempson Ealing Lettings  
1 The Broadway, London, W5  
2NT  
020 8840 7885  
ealinglettings@robertsonsmithandkempson.co.uk

Energy Rating: C. We aim to make our particulars both accurate and reliable. However they are not guaranteed; nor do they form part of an offer or contract. If you require clarification on any points then please contact us, especially if you're traveling some distance to view. Please note that appliances and heating systems have not been tested and therefore no warranties can be given as to their good working order.