



Bradley Gardens, W13

£1,425,000

Offering nearly 2000 sq ft, this beautiful family home set over three floors offers a perfect balance of family living space, bedrooms and a spacious sun-trapped secluded garden.

A stunning property, the ground floor comprises two large reception rooms, downstairs toilet and extended kitchen/diner filled with natural light leading to the secluded garden.



A stunning property, the ground floor comprises two large reception rooms, downstairs toilet and extended kitchen/diner filled with natural light leading to the secluded garden.

The first floor offers three double bedrooms (one of which is en suite shower) and additional family bathroom. The loft has been tastefully converted to include a large double bedroom, additional bedroom and shower room. An abundance of storage throughout the house.

Ideally located for transport links including Elizabeth Line at West Ealing (0.3 miles) providing easy access to London. Many local parks including Cleveland and Pitshanger Park to enjoy. Well regarded schools including the Ofsted outstanding Insights Independent.

- Nearly 2000 Sq Ft • Five Bedrooms • Local Parks •
- Spacious Secluded Garden • Excellent Transport Links • Ofsted Outstanding Schools •



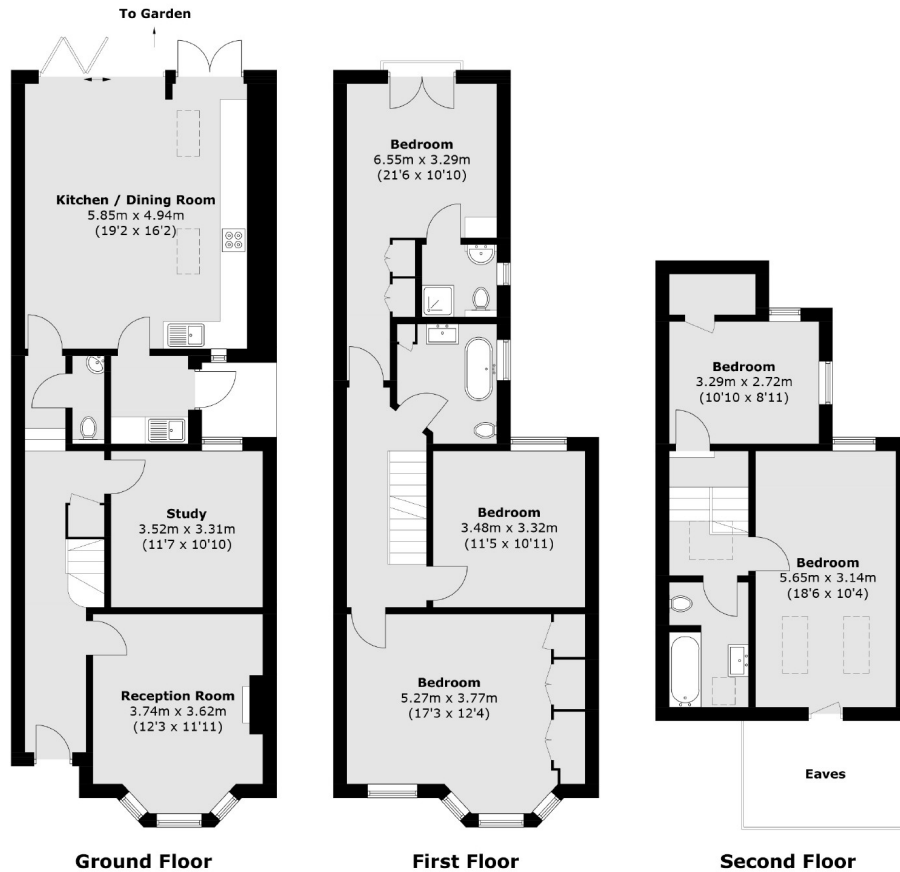

Total area (approx.): 183.0 sq. m (1,969.8 sq. ft)
(Excluding Eaves)

Robertson Smith & Kempson Ealing Sales
1 The Broadway, London,
W5 2NT
020 8840 7677
ealingsales@robertsonsmithandkempson.co.uk

Energy Rating: D. We aim to make our particulars both accurate and reliable. However they are not guaranteed; nor do they form part of an offer or contract. If you require clarification on any points then please contact us, especially if you're traveling some distance to view. Please note that appliances and heating systems have not been tested and therefore no warranties can be given as to their good working order.