

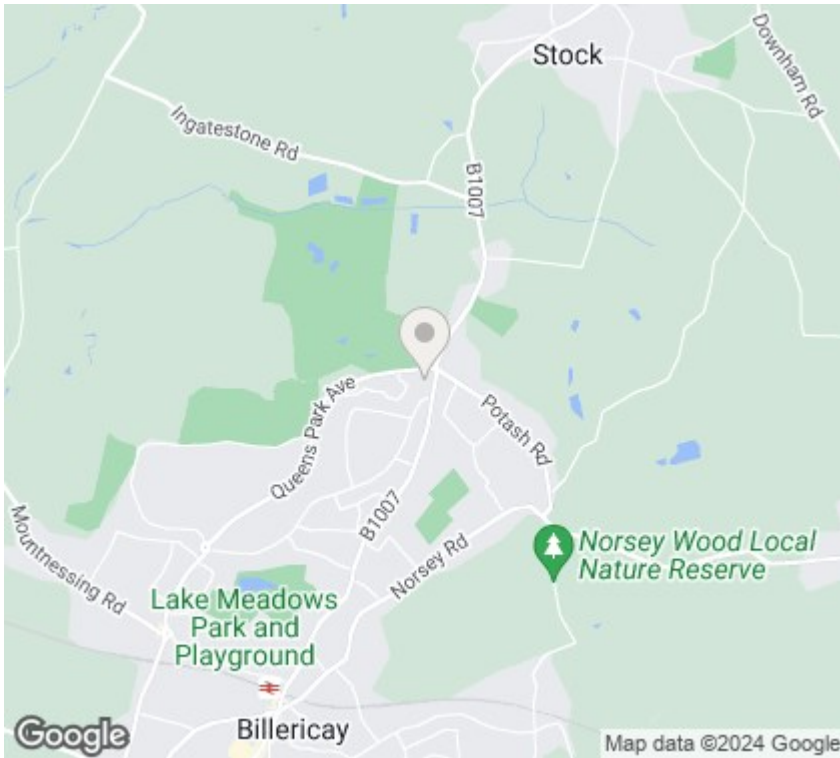

34 Arundel Way, Billericay, Essex, CM12 0FL

Asking Price £825,000

- BEAUTIFULLY PRESENTED
- FIVE DOUBLE BEDROOMS
- STUNNING KITCHEN / DINING ROOM
- CONSERVATORY
- 60' X 54' REAR GARDEN
- AMAZING FAMILY HOME
- BONUS LOFT ROOM
- GOOD SIZED LOUNGE
- DOUBLE GARAGE
- VIEWING ESSENTIAL



Viewings

Viewings by arrangement only. Call 01277 626 541 to make an appointment.

Council Tax Band:

G

EPC Rating:

D

Energy Efficiency Rating		Current	Potential
Very energy efficient - lower running costs			
(92 plus)	A		82
(81-91)	B		
(69-80)	C		
(55-68)	D	64	
(39-54)	E		
(21-38)	F		
(1-20)	G		
Not energy efficient - higher running costs			
England & Wales		EU Directive 2002/91/EC	

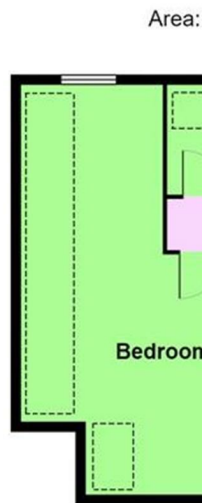
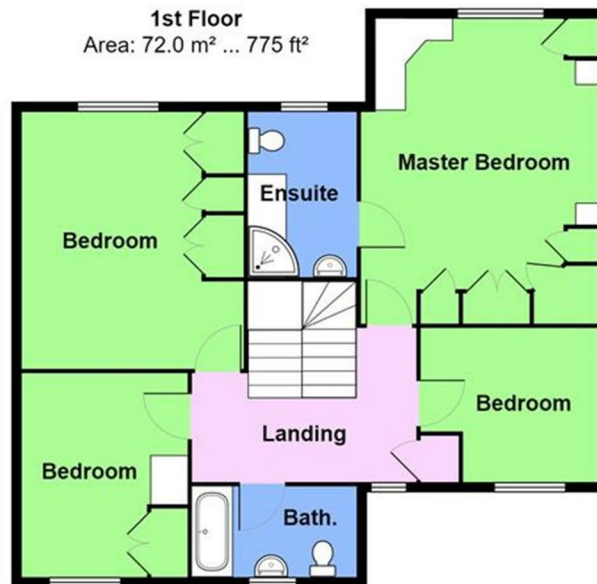

Total Area: 231.9 m² ... 2497 ft²

Whilst every effort has been made to ensure accuracy, measurements of doors, windows and other items are approximate and no responsibility is taken for any error, omission or misstatement. This plan is for illustrative purposes and so only be used as such.