

www.churchandhawes.com
4/6 High Street, Maldon, Essex, CM9 5PJ
Tel: 01621 855195
maldon@churchandhawes.com

Church & Hawes

Est.1977

Estate Agents, Valuers, Letting & Management Agents



3a King Georges Place, Maldon, CM9 5BZ Price £200,000

****CASH BUYERS ONLY!**** ****REQUIRING REFURBISHMENT & MODERNISATION!**** An opportunity has arisen to purchase this duplex apartment situated in the heart of Maldon's historic High Street and within walking distance of cafe's, shopping facilities bars and restaurants along with the Promenade Park and Hythe Quay. The roof terrace boasts stunning views over Maldon & beyond. Internally the property has versatile accommodation with three/four bedrooms (PLEASE REFER TO FLOORPLAN FOR LAYOUT). Energy Efficiency Rating E. Council Tax Band C. Leasehold (long lease of approx 974 years)



Accommodation

- Roof Terrace
- Three/Four Bedrooms
- Lounge
- Kitchen
- Terrace
- Two Shower Rooms

Agents Note

These particulars do not constitute any part of an offer or contract. All measurements are approximate. No responsibility is accepted as to the accuracy of these particulars or statements made by our staff concerning the above property. We have not tested any apparatus or equipment therefore cannot verify that they are in good working order. Any intending purchaser must satisfy him/herself as to the correctness of such statements within these particulars. All negotiations to be conducted through Church and Hawes. No enquiries have been made with the local authorities pertaining to planning permission or building regulations. Any buyer should seek verification from their legal representative or surveyor. When purchasing a leasehold property the terms & details of the lease should be checked, clarified & confirmed via your solicitors.

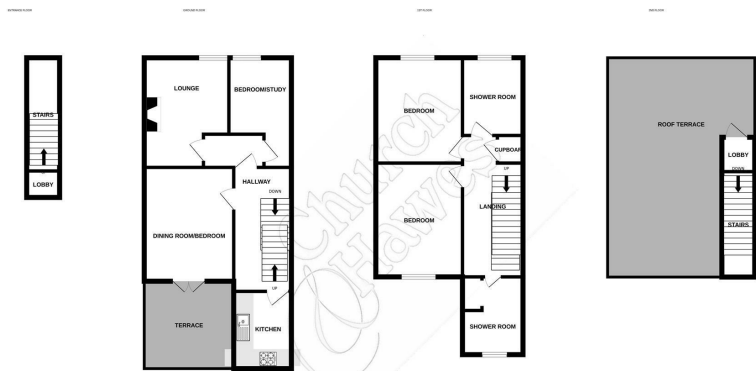
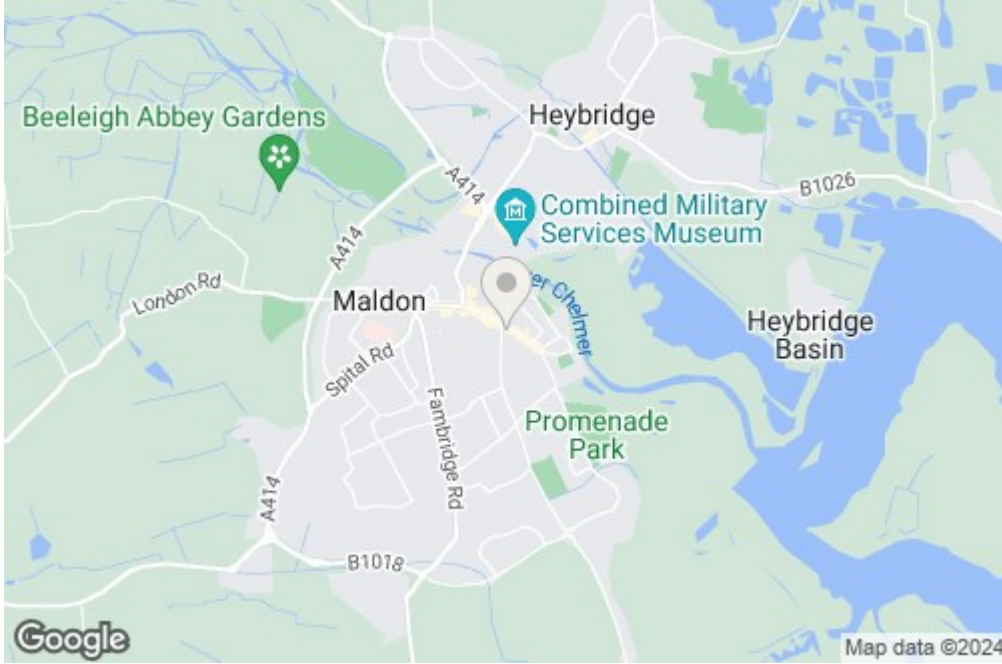

While every attempt has been made to ensure the accuracy of the floorplan contained here, measurements of areas, windows, doors and any other items are approximate and no responsibility is taken for any error, omission or mis-statement. This plan is for illustrative purposes only and should be used as such for any prospective purchaser. The services, suppliers and appliances shown here are not been tested and no guarantee is to the quality or quantity of any of them. Made with Merge3 ©2023

