



Westminster Close, Kempshott Rise, Basingstoke, RG22 4PP

£620,000 - Freehold



Barons Estate Agents are pleased to bring to the market this family home. The accommodation to the first floor comprises of master bedroom with en suite shower, 3 further bedrooms and family bathroom. The ground floor benefits from an entrance hall, cloakroom, lounge, study, utility room and open plan kitchen/dining/breakfast room. To the front of the property there is a mature garden, double width garage and driveway parking, side access to the rear garden. The rear garden is a corner plot and enjoys a patio, decked area lawn and mature shrubs. Viewing is recommended by the owner’s agents.

Key Points and Features

- 4 Bedrooms
 - Kitchen/Dining Room
 - Study
- 2 Bathrooms
 - Utility Room
 - Double Garage
- Entrance Hall
 - Lounge
 - Garden

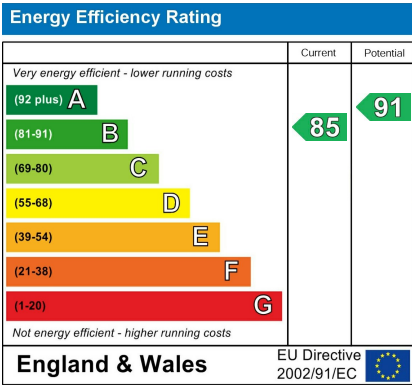
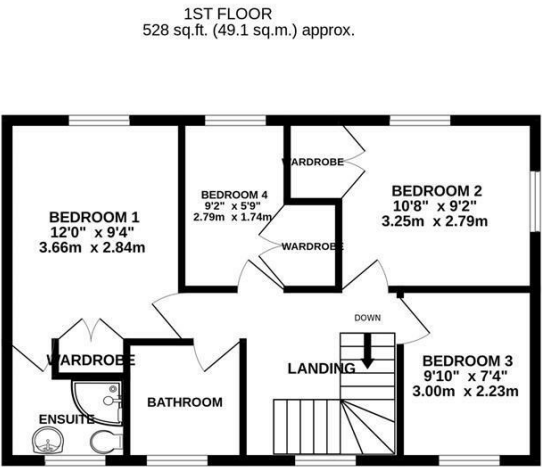
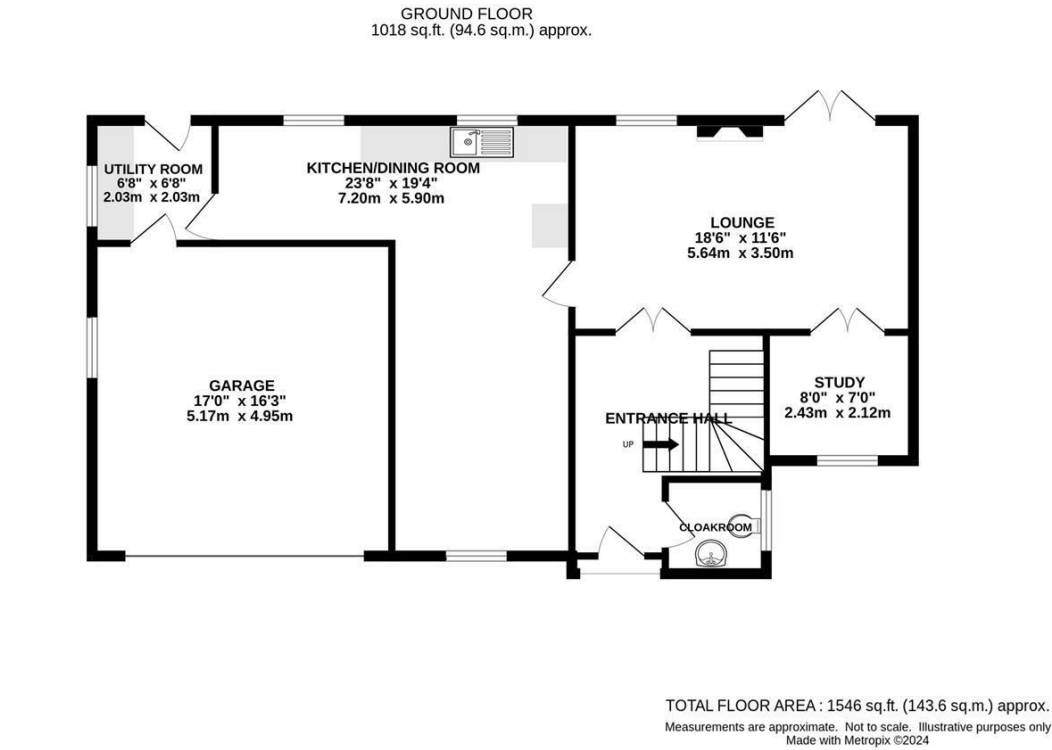

Location
Westminster Close is on the sought after Kempshott Rise development which merges into Hatch Warren which benefits from amenities including St Marks C of E School, Busy Bee Nursery and Retail Park which includes Sainsbury Super Store, Argos, and Pets At Home. For the keen shopper Festival Place offers more extensive shopping facilities including Marks & Spencer's and a John Lewis Store. The town offers an abundance of eateries, pubs, and two theatres'. A Leisure Park is close by offering ice skating, bowling, a swimming pool, and a pitch and putt.

Local Authority
Basingstoke & Deane Borough Council

Council Tax
Band F

Viewing Arrangements
Viewings are to be arranged via Barons Estate Agents, Basingstoke.

Tenure
Freehold

Extra Services
Barons Estate Agents will recommend the services of other businesses and may receive a referral fee in some instances where a buyer or seller uses the services of that company.