



Park Prewett Road, Rooksdown, Basingstoke, RG24 9RG

£295,000 Guide price - Freehold



Barons Estate Agents are delighted to present this two bedroom, mid terrace property situated in Rookdown. The property has been lovingly cared for by the current owner, and is presented to the market in immaculate condition in our opinion. The ground floor accommodation comprises of an entrance hallway, lounge, kitchen/dining room, rear hallway and cloakroom. Upstairs there are two double bedrooms, and a modern family bathroom. Externally, the property boasts an enclosed rear garden, a shed with power, an allocated, offroad parking space and communal parking on the road. Additional benefits include gas central heating and double glazing throughout. An early viewing would be strongly advised by the vendor's sole agent.

Key Points and Features

- Mid Terrace Home
- Lounge
- Enclosed Rear Garden
- Two Double Bedrooms
- Kitchen/Dining Room
- Gas Heating & Double Glazing
- Modern Family Bathroom
- Cloakroom
- Allocated Parking

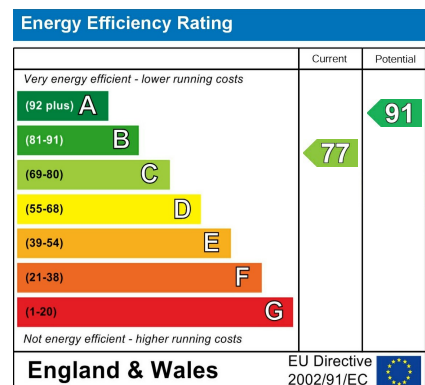
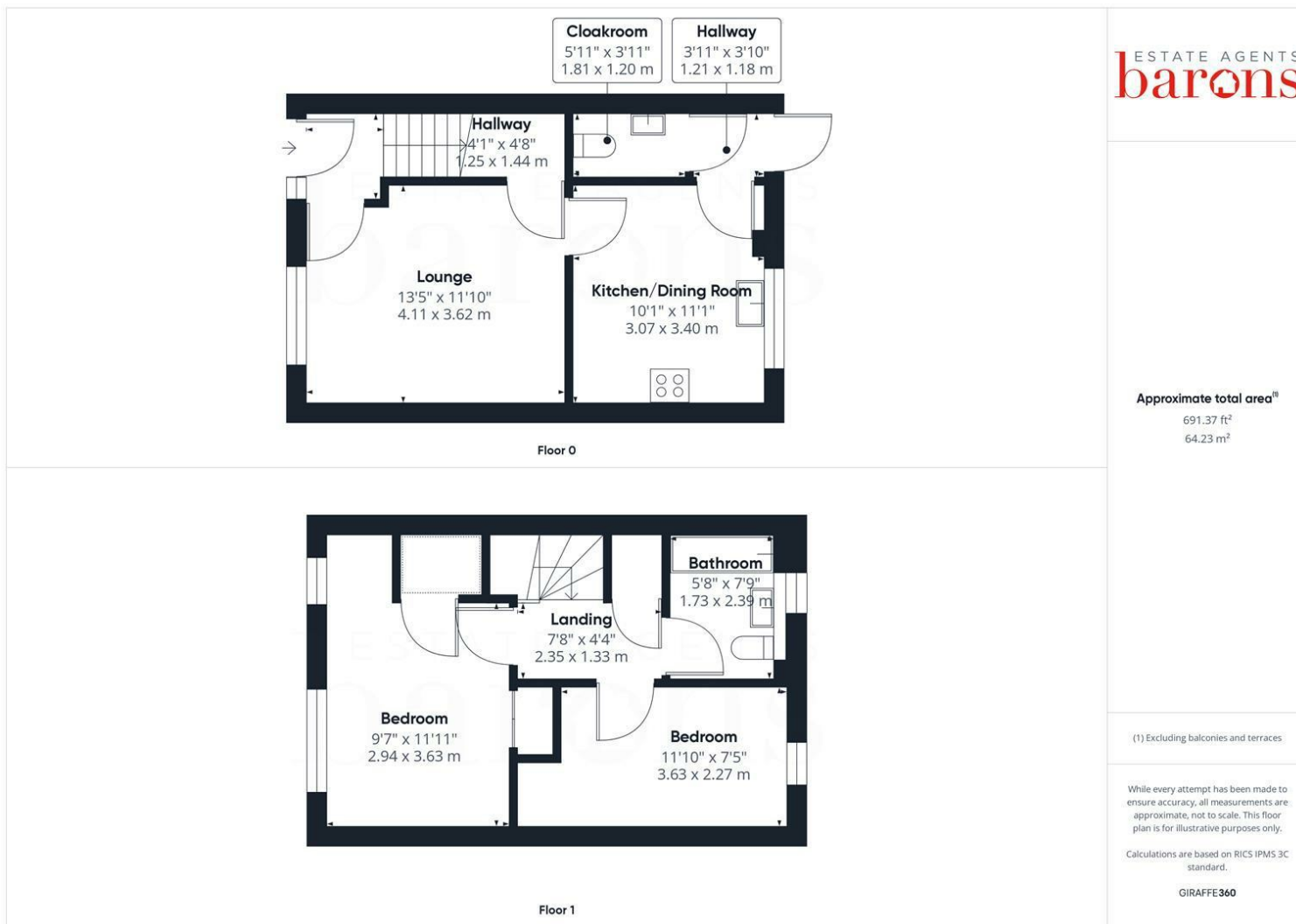

Location

Park Prewett Road is situated in the popular development of Rookdown. Conveniently located for Basingstoke hospital and offering a local shop and cafe. Further amenities are on offer in Basingstoke Town Centre, which include Festival Place shopping centre, mainline train line, 10 screen cinema and a vast selection of bars & eateries. The A339 and M3 are easily accessible giving commuters access to Newbury, London and the South. The Property is also a short walk to Castle Hill Primary School.

Local Authority

Basingstoke & Deane Borough Council

Council Tax Band

Band C

Viewing Arrangements

Viewings are to be arranged via Barons Estate Agents.

Tenure

Freehold

Extra Services

Barons Estate Agents will recommend the services of other businesses and may receive a referral fee in some instances where a buyer or seller uses the services of that company.