

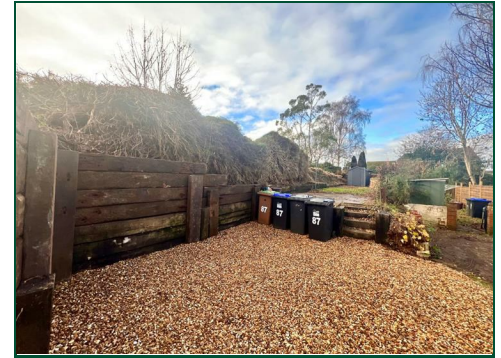

Northampton Road
Brixworth, Northamptonshire

oriordanbond
SALES & LETTINGS



Northampton Road

Brixworth

NN6 9DX

PRICE £240,000

Offered with no onward chain is this delightful two bedroom period stone cottage under a slate roof, with a 90ft westerly facing garden and off road parking, situated in the conservation area of the thriving village of Brixworth.

The property has gas radiator heating and comprises sitting room, modern kitchen with integrated appliances, stairs rising to the first floor, two bedrooms and a modern bathroom with shower over bath. Externally to the rear is off road parking for two cars, two outbuildings for storage, a garden shed and a 90ft westerly facing garden. (B/507/L)

Additional information

- Council Tax Band: B
- Energy Efficiency Rating: C

Viewing

Viewing strictly by appointment – details below

Disclaimer

O'Riordan Bond Estate Agents Limited has not tested apparatus, equipment, fittings or services and so cannot verify they are in working order. The buyer is advised to obtain verification from their solicitor or surveyor.

O'Riordan Bond Brixworth Sales

01604 880077

brixworth@oriordanbond.co.uk

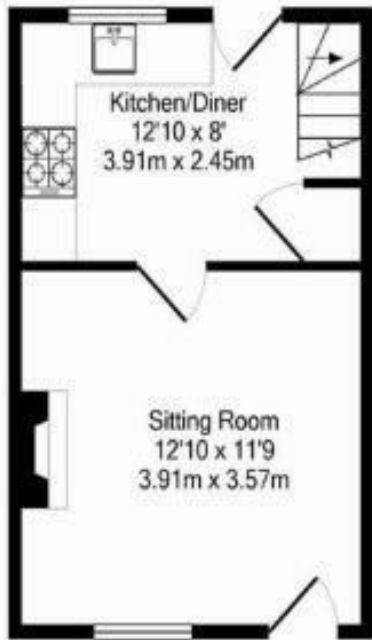

Ground Floor
Approx. Floor
Area 253 Sq.Ft.
(23.5 Sq.M.)

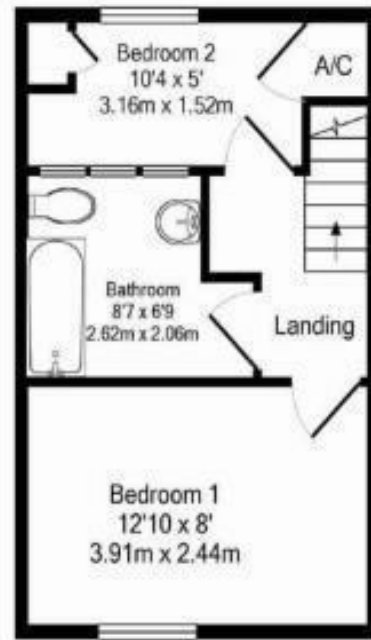

1st Floor
Approx. Floor
Area 253 Sq.Ft.
(23.5 Sq.M.)

87 Northampton Road Brixworth Nn6 9dx
Total Approx. Floor Area 507 Sq.Ft. (47.1 Sq.M.)
Measurements are approximate. Not to scale. Illustrative purposes only
Made with MetroPix ©2011

