



Ash Rise

Kingsthorpe, Northampton

oriordanbond
SALES & LETTINGS



GROUND FLOOR
602 sq.ft. (55.9 sq.m.) approx.

1ST FLOOR
329 sq.ft. (30.6 sq.m.) approx.

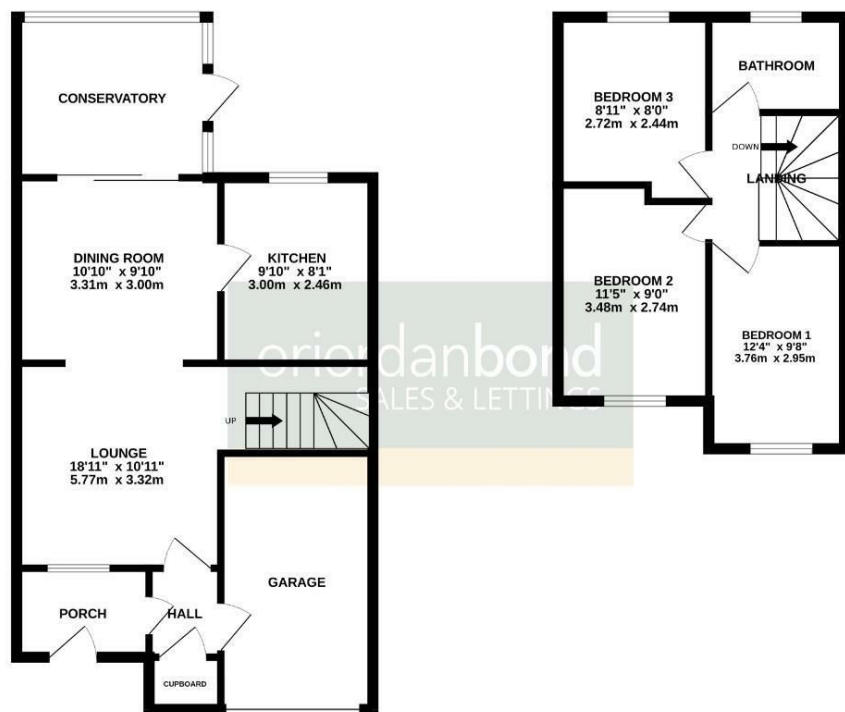

TOTAL FLOOR AREA: 931 sq.ft. (86.5 sq.m.) approx.

Whilst every attempt has been made to ensure the accuracy of the floorplans contained herein, measurements of doors, windows, rooms and any other items are approximate and no responsibility is taken for any error, omission or mis-statement. This plan is for illustrative purposes only and should be used as such by any prospective purchaser. The services, systems and appliances shown have not been tested and no guarantee as to their operability or efficiency can be given.
Made with: floorplan.co.uk

Ash Rise

Kingsthorpe

NN2 8SB

OFFERS OVER £280,000

Offered to the market is this well presented three bedroom end terraced family home located in the popular area of Kingsthorpe. The property is within walking distance of local schools, amenities and playing fields.

The accommodation comprises entrance hall, open plan sitting/dining room, separate kitchen and conservatory. To the first floor are three bedrooms and a family bathroom. Outside is a private enclosed rear garden and a block paved driveway to the front providing off road parking for two cars leading to an integral garage. Further benefits include uPVC double glazing and gas radiator heating. (B/931/S)

Additional information

- Council Tax Band: B
- Energy Efficiency Rating: D

Viewing

Viewing strictly by appointment – details below

Disclaimer

O'Riordan Bond Estate Agents Limited has not tested apparatus, equipment, fittings or services and so cannot verify they are in working order. The buyer is advised to obtain verification from their solicitor or surveyor.

O'Riordan Bond Kingsthorpe Sales

01604 722007

kingsthorpe@oriordanbond.co.uk

