



Norfolk Street

Semilong, Northampton

oriordanbond
SALES & LETTINGS



GROUND FLOOR
445 sq. ft. (41.3 sq. m.) approx.



1ST FLOOR
389 sq. ft. (36.2 sq. m.) approx.



Norfolk Street

Semilong

NN2 6HR

PRICE £190,000

Offered to the market with no onward chain is this three bedroom terraced property situated in the popular area of Semilong. The property is ideally located and has easy access to amenities, schools and within walking distance to Northampton train station.

The accommodation comprises entrance hall, open plan sitting/dining room, kitchen with access to a cellar and rear garden and a downstairs family bathroom. From the first floor landing are three double bedrooms. Outside is an enclosed rear garden with. Further benefits include gas radiator heating and uPVC double glazing. (C/834/S)

Additional information

- Council Tax Band: A
- Energy Efficiency Rating: D

Viewing

Viewing strictly by appointment – details below

Disclaimer

O'Riordan Bond Estate Agents Limited has not tested apparatus, equipment, fittings or services and so cannot verify they are in working order. The buyer is advised to obtain verification from their solicitor or surveyor.

O'Riordan Bond Kingsthorpe Sales

01604 722007

kingsthorpe@oriordanbond.co.uk

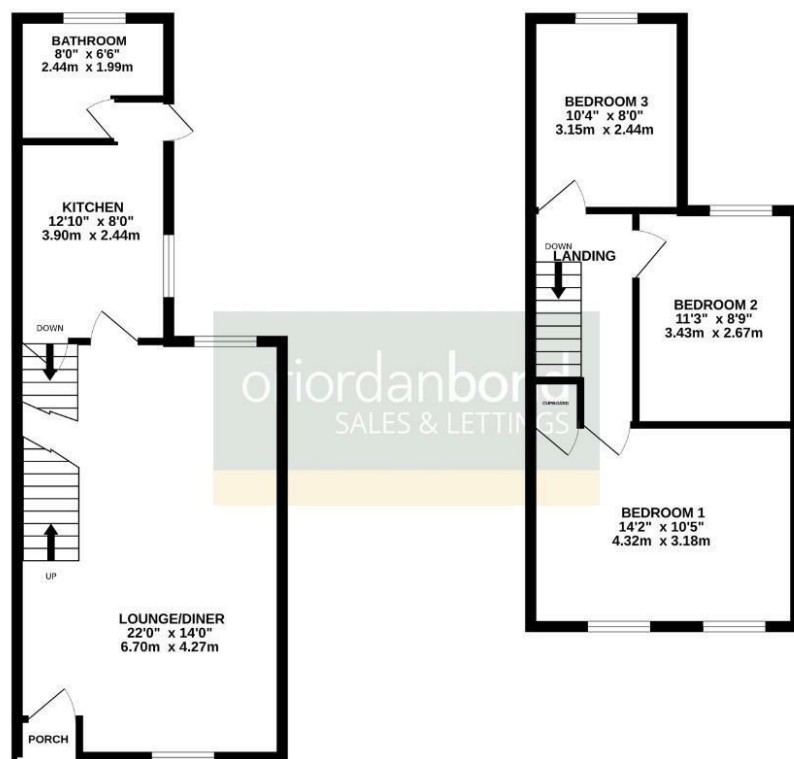

TOTAL FLOOR AREA : 834 sq. ft. (77.5 sq. m.) approx.

Whilst every attempt has been made to ensure the accuracy of the floorplan contained here, measurements of doors, windows, stairs and any other items are approximate and no responsibility is taken for any error, omission or misstatement. This plan is for illustrative purposes only and should be used as such by any prospective purchaser. The services, systems and appliances shown have not been tested and no guarantee as to their operability or efficiency can be given.
Made with floorplan.co.uk