



Balfour Close

Kingsthorpe, Northampton

oriordanbond
SALES & LETTINGS



GROUND FLOOR
707 sq.ft. (65.6 sq.m.) approx.

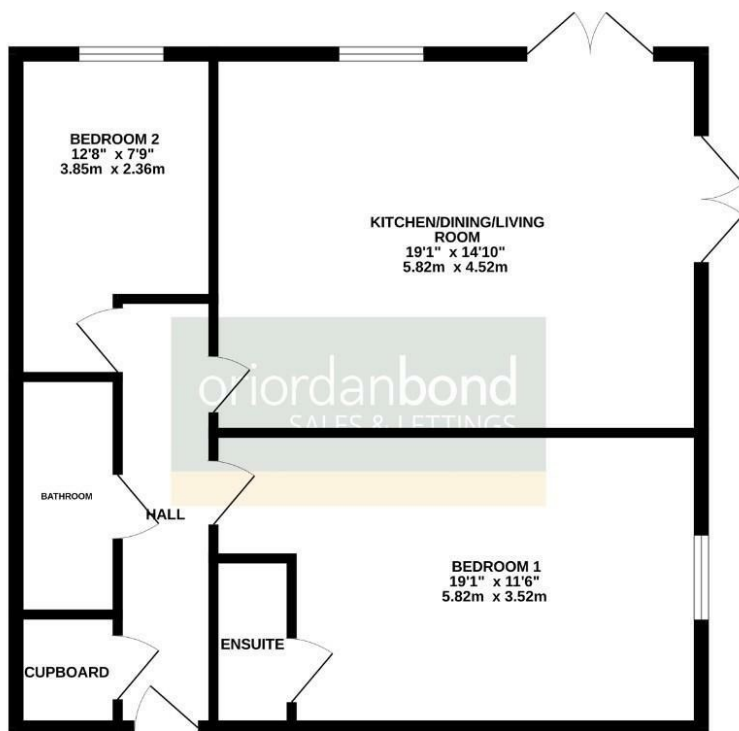

TOTAL FLOOR AREA: 707 sq.ft. (65.6 sq.m.) approx.

Whilst every attempt has been made to ensure the accuracy of the floorplan contained here, measurements of doors, windows, rooms and any other items are approximate and no responsibility is taken for any error, omission or misstatement. This plan is for illustrative purposes only and should be used as such by any prospective purchaser. The services, systems and appliances shown have not been tested and no guarantee as to their operability or efficiency can be given.
Made with Metrepro C2024

Balfour Close

Kingsthorpe

NN2 6LL

PRICE £130,000

A modern two bedroom top floor apartment located in a private development, ideal for investment and first time buyers, close to local schools, amenities and Northampton train station. Offered for sale with no onward chain.

Accommodation comprises entrance hall, kitchen and living room with double opening doors to a Juliette balcony. Also offset from the entrance hall are two bedrooms, storage cupboards and a three-piece bathroom. Outside is an allocated parking space for one vehicle. Further benefits include uPVC double glazing and gas radiator heating. (B/574/-)

Leasehold Information: Lease Remaning - 979 years (as of 2024) / Ground Rent - £TBC / Service Charge - £850 per annum

Additional information

- Council Tax Band: B
- Energy Efficiency Rating: C

Viewing

Viewing strictly by appointment – details below

Disclaimer

O'Riordan Bond Estate Agents Limited has not tested apparatus, equipment, fittings or services and so cannot verify they are in working order. The buyer is advised to obtain verification from their solicitor or surveyor.

O'Riordan Bond Kingsthorpe Sales

01604 722007

kingsthorpe@oriordanbond.co.uk

