



Obelisk Rise

Kingsthorpe, Northampton

oriordanbond
SALES & LETTINGS



Obelisk Rise

Kingsthorpe
NN2 8QU

Guide Price
£280,000

A well presented and extended three/four bedroom semi-detached house, located in the sought after Obelisk Rise in Kingsthorpe. The property is within walking distance to local schools, shops and a public bus stop.

Accommodation comprises large entrance hall with cloakroom/WC, re-decorated dining room/bedroom four, large sitting room which leads into a well presented conservatory, extended kitchen with breakfast bar and side access, three first floor bedrooms and a re-fitted family bathroom. Outside is a landscaped rear garden with brick-built storage unit. To the front of the property is a driveway providing off road parking for several vehicles. Further benefits include uPVC double glazing and gas radiator heating (B/943/M)

- Extended three/four bedroom semi-detached
- Extended kitchen/breakfast room
- Conservatory
- Gas radiator heating
- Enclosed landscaped rear garden
- Off road parking





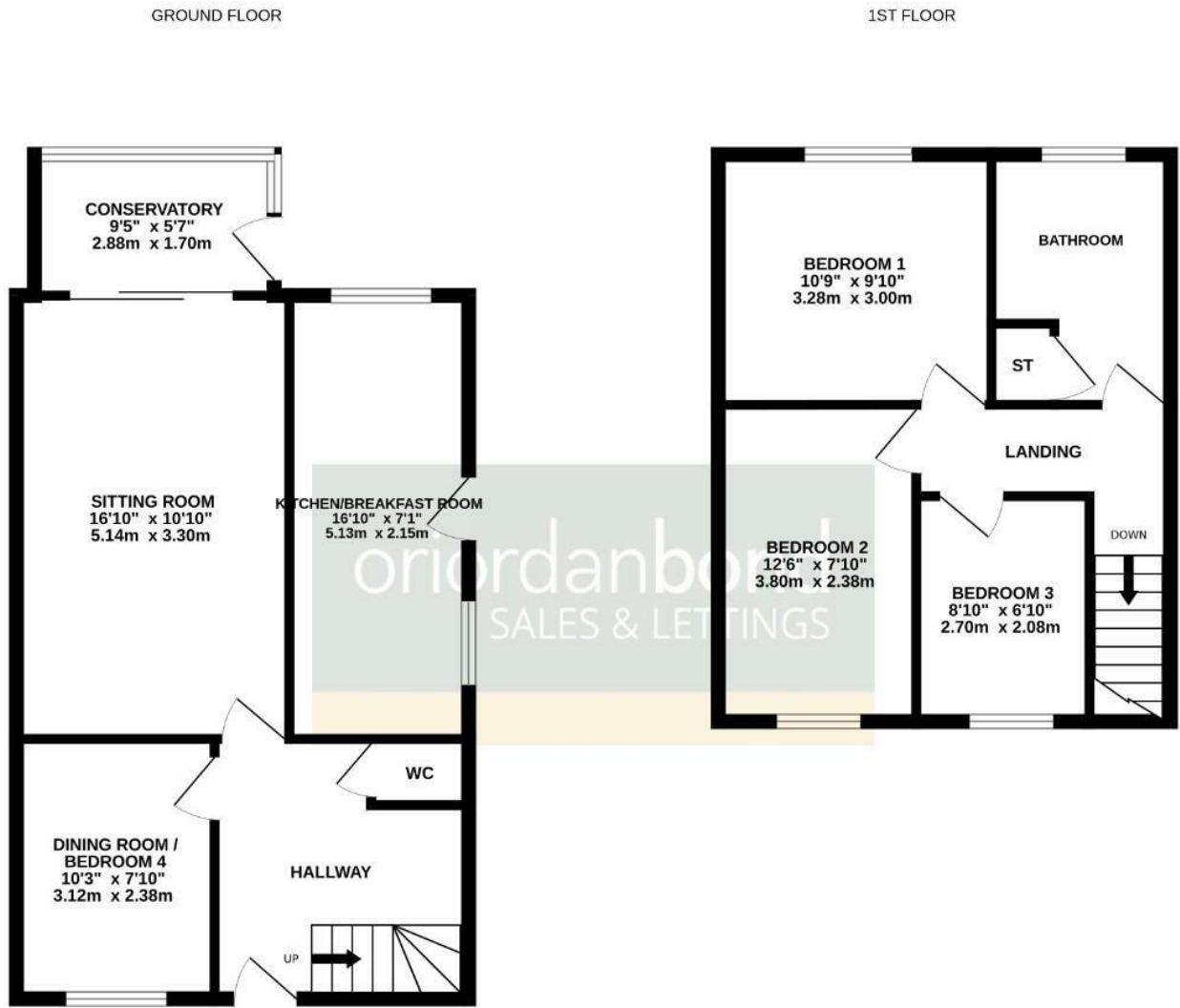

TOTAL FLOOR AREA : 943 sq.ft. (87.6 sq.m.) approx.
 Whilst every attempt has been made to ensure the accuracy of the floorplan contained here, measurements of doors, windows, rooms and any other items are approximate and no responsibility is taken for any error, omission or mis-statement. This plan is for illustrative purposes only and should be used as such by any prospective purchaser. The services, systems and appliances shown have not been tested and no guarantee as to their operability or efficiency can be given.
 Made with Metropix ©2024

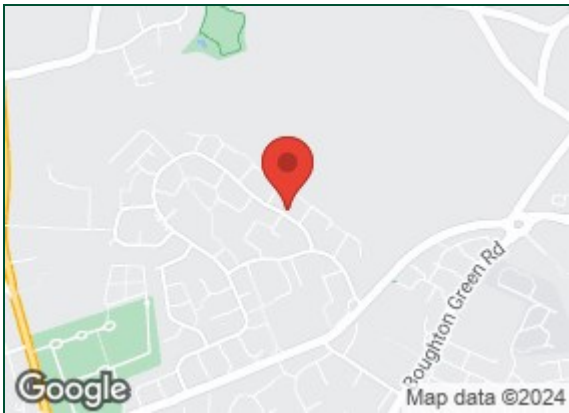

Additional information

- Council Tax Band: C
- Energy Efficiency Rating: D

Viewing

Viewing strictly by appointment – details below

Disclaimer

O’Riordan Bond Estate Agents Limited has not tested apparatus, equipment, fittings or services and so cannot verify they are in working order. The buyer is advised to obtain verification from their solicitor or surveyor.

O’Riordan Bond Kingsthorpe Sales
 01604 722007

kingsthorpe@oriordanbond.co.uk

