



22 Everdon Drive
Kingsthorpe, Northampton

oriordanbond
SALES & LETTINGS



GROUND FLOOR

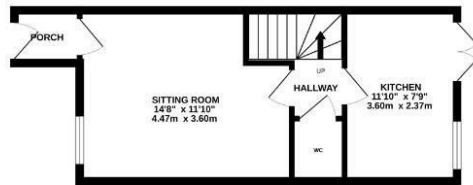

1ST FLOOR

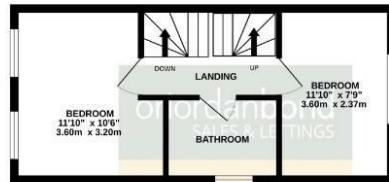

2ND FLOOR

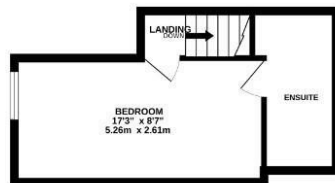

TOTAL FLOOR AREA : 864 sq.ft. (80.3 sq.m.) approx.

Whilst every attempt has been made to ensure the accuracy of the floorplan contained here, measurements of doors, windows, rooms and any other items are approximate and no responsibility is taken for any error, omission or mis-statement. This plan is for illustrative purposes only and should be used as such by any prospective purchaser. The services, systems and appliances shown have not been tested and no guarantee as to their operability or efficiency can be given. Made with Metrepx 02023.

22 Everdon Drive

Kingsthorpe

NN2 7FR

PRICE £290,000

A modern three bedroom semi-detached family home located on the popular Scholars Green development in Kingsthorpe. The property is ideally located within walking distance of local schools and amenities.

Accommodation comprises entrance hall, sitting/dining room, cloakroom/WC and a kitchen with fitted appliances and French doors to the rear garden. On the first floor are two double bedrooms and a family bathroom. To the second floor is a master bedroom with en-suite. Outside is an enclosed rear garden with patio area leading to laid lawn and side access. To the front of the property is a driveway providing off road parking and a small low maintenance garden. Further benefits include uPVC double glazing and gas radiator heating (B/864/S)

Additional information

- Council Tax Band: B
- Energy Efficiency Rating: B

Viewing

Viewing strictly by appointment – details below

Disclaimer

O’Riordan Bond Estate Agents Limited has not tested apparatus, equipment, fittings or services and so cannot verify they are in working order. The buyer is advised to obtain verification from their solicitor or surveyor.

O’Riordan Bond Kingsthorpe Sales
01604 722007

kingsthorpe@oriordanbond.co.uk

