



# Lily Close

Burton Latimer, Northamptonshire

oriordanbond  
LETTINGS





## Lily Close

Burton Latimer

NN15 5GD

£950 PCM

A lovely two double bedroom home within the thriving village of Burton Latimer with many local amenities. The accommodation comprises entrance hall, cloakroom/WC, sitting/dining room, fitted kitchen, two double bedrooms and a family bathroom. Outside is allocated parking to the front and a tiered rear garden. Further benefits include uPVC double glazing and gas radiator heating.

### Tenancy Information

- Deposit: £1096 (1 Week Holding Deposit - £219.23)
- Smokers: Not Allowed
- Pets: Not Allowed
- Unfurnished
- Length of Tenancy: 12 Months
- Available: Early August 2024

### Additional information

- Council Tax Band: B
- Energy Efficiency Rating: B

### Viewing

Viewing strictly by appointment – details below

### Disclaimer

O'Riordan Bond Estate Agents Limited has not tested apparatus, equipment, fittings or services and so cannot verify they are in working order. The buyer is advised to obtain verification from their solicitor or surveyor.

O'Riordan Bond Weston Favell Lettings  
01604 814400

lettingswestonfavell@oriordanbond.co.uk



GROUND FLOOR

1ST FLOOR

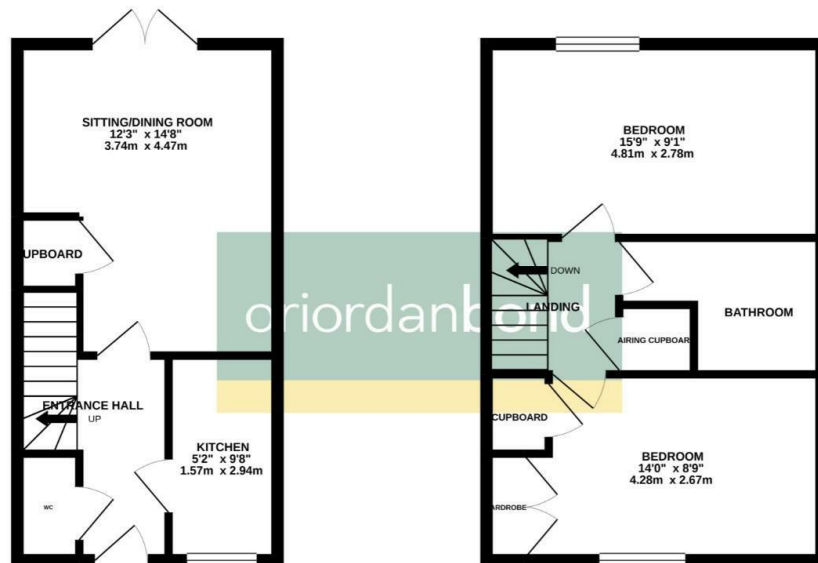

TOTAL FLOOR AREA: 721sq ft. (67.0 sq m) approx.

Whilst every attempt has been made to ensure the accuracy of the floorplan concerned here, measurements of doors, windows, rooms and any other items are approximate and no responsibility is taken for any error, omission or mis-statement. This plan is for illustrative purposes only and should be used as such by any prospective purchaser. The services, systems and appliances shown have not been tested and no guarantee as to their operability or efficiency can be given.

Made with Metropix G2021