



Dore Close

The Maltings, Northampton

oriordanbond
SALES & LETTINGS



Ground Floor

Approx. 33.1 sq. metres (356.8 sq. feet)

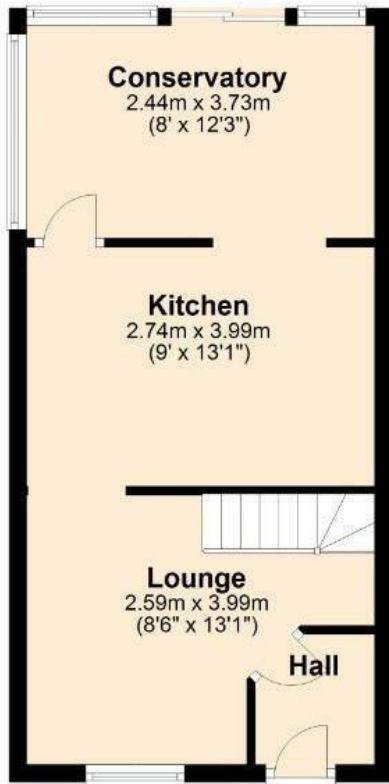

First Floor

Approx. 25.7 sq. metres (277.0 sq. feet)

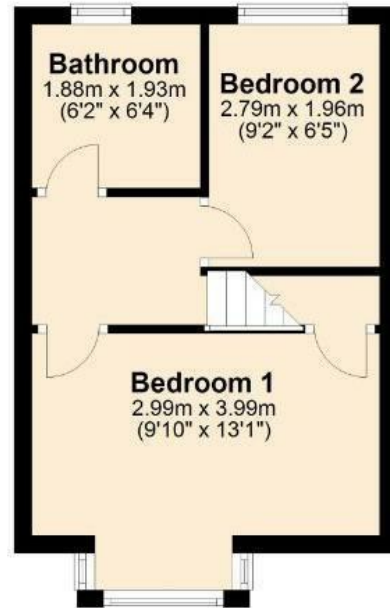

Total area: approx. 58.9 sq. metres (633.7 sq. feet)

Dore Close

The Maltings

NN3 8NJ

OFFERS OVER £200,000

A well presented two bedroom modern terrace property situated within this popular cul-de-sac location of The Maltings, offered to the market with no onward chain.

The accommodation comprises entrance porch, sitting room, refitted kitchen/dining, conservatory, two first floor bedrooms and a modern fitted bathroom. Outside is an enclosed south facing garden to the rear, a front garden and allocated parking. Further benefits include uPVC double glazing and gas radiator heating. (B/633/M)

Additional information

- Council Tax Band: A
- Energy Efficiency Rating: C

Viewing

Viewing strictly by appointment – details below

Disclaimer

O'Riordan Bond Estate Agents Limited has not tested apparatus, equipment, fittings or services and so cannot verify they are in working order. The buyer is advised to obtain verification from their solicitor or surveyor.

O'Riordan Bond Weston Favell Sales

01604 784007

westonfavell@oriordanbond.co.uk

