



Meltham Close

Beau Manor, Northampton

oriordanbond
SALES & LETTINGS



GROUND FLOOR



1ST FLOOR

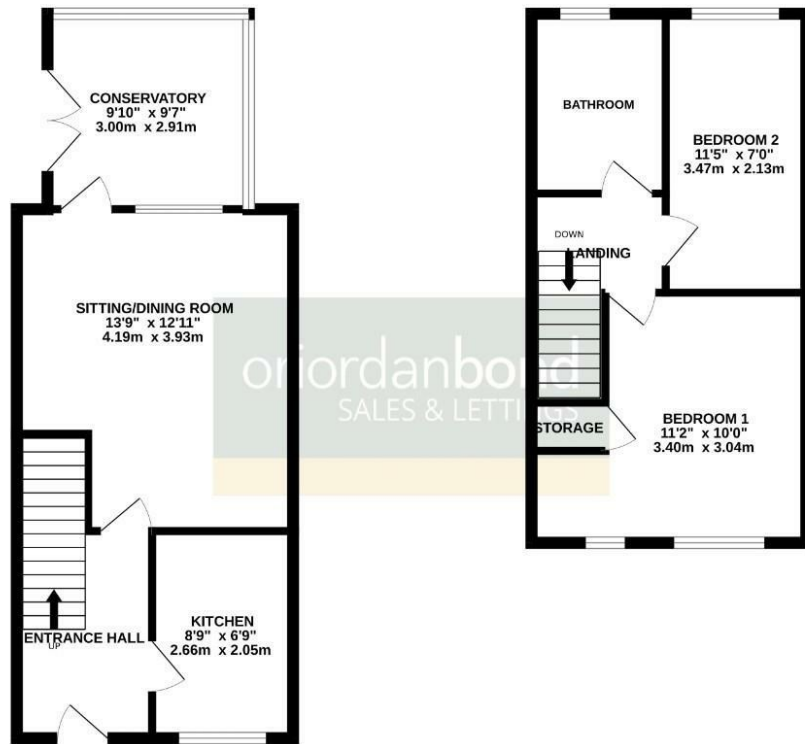

TOTAL FLOOR AREA : 792 sq ft. (73.6 sq.m.) approx.

While every attempt has been made to ensure the accuracy of the floorplan contained here, measurements of doors, windows, access and any other items are approximate and no responsibility is taken for any error, omission or mis-statement. This plan is for illustrative purposes only and should be used as such by any prospective purchaser. The services, systems and appliances shown have not been tested and no guarantee as to their operability or efficiency can be given. Made with Metreplus. ©2024

Meltham Close

Beau Manor

NN3 9QY

OFFERS OVER £220,000

A modern two bedroom semi-detached property, situated in the popular location of Beau Manor, within close proximity to Weston Favell Shopping Centre and Northampton Academy. This home is presented in immaculate condition throughout.

Offered with no onward chain, the accommodation comprises entrance hall, fitted kitchen, sitting/dining room, conservatory, two bedrooms and a modern shower room. Outside is a front garden with driveway and a private rear garden. Further benefits include gas radiator heating with a combi boiler. (B/792/S)

Additional information

- Council Tax Band: B
- Energy Efficiency Rating: D

Viewing

Viewing strictly by appointment – details below

Disclaimer

O'Riordan Bond Estate Agents Limited has not tested apparatus, equipment, fittings or services and so cannot verify they are in working order. The buyer is advised to obtain verification from their solicitor or surveyor.

O'Riordan Bond Weston Favell Sales

01604 784007

westonfavell@oriordanbond.co.uk

