



6 Chesham Rise

Cherry Lodge, Northampton

oriordanbond
SALES & LETTINGS



6 Chesham Rise

Cherry Lodge
NN3 8PX

OFFERS OVER
£254,500

A modern three bedroom semi-detached property with good size living accommodation, in a private cul-de-sac, within the popular area of Cherry Lodge. Offered for sale with no onward chain, the property is just a short walk from local shops and schooling.

Accommodation comprises entrance porch, sitting/dining room, fitted kitchen, conservatory and a home office/play room which has been part converted from the garage. To the first floor are three good size bedrooms and a family bathroom. Outside is an enclosed rear garden with lawn and patio and a front lawned garden with driveway providing off road parking leading to the garage store. Further benefits include uPVC double glazing and gas radiator heating. (B/950/M)

Additional information

- Council Tax Band: B
- Energy Efficiency Rating: D

Viewing

Viewing strictly by appointment – details below

Disclaimer

O'Riordan Bond Estate Agents Limited has not tested apparatus, equipment, fittings or services and so cannot verify they are in working order. The buyer is advised to obtain verification from their solicitor or surveyor.

O'Riordan Bond Weston Favell Sales
01604 784007

westonfavell@oriordanbond.co.uk



GROUND FLOOR

1ST FLOOR

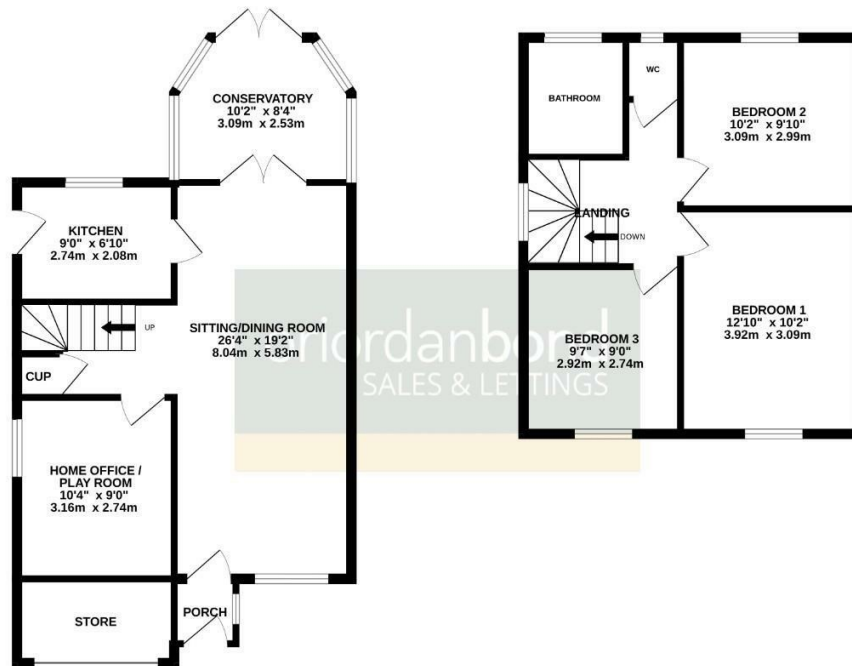

TOTAL FLOOR AREA: 950sq. ft. (88.3 sq. m.) approx.

Whilst every attempt has been made to ensure the accuracy of the floorplan contained here, measurements of doors, windows, floors and any other items are approximate and no responsibility is taken for any error, omission or mis-statement. This plan is for illustrative purposes only and should be used as such by any prospective purchaser. The services, systems and appliances shown have not been tested and no guarantee as to their operability or efficiency can be given. Made with MyPlan 02024