



11 Healey Close
Rectory Farm, Northampton

oriordanbond
SALES & LETTINGS



11 Healey Close

Rectory Farm

NN3 5JU

£335,000

A well presented and well proportioned detached home situated in this popular cul-de-sac within Rectory Farm. Benefits include gas radiator heating and uPVC double glazing.

The property is offered to the market with accommodation comprising reception hall, re-fitted ground floor shower room, sitting/dining room, re-fitted kitchen and a conservatory. The first floor provides four double bedrooms and a re-fitted family bathroom. Outside are well presented front and rear gardens, including a large block paved patio area, and a driveway leading to a single garage. (B/1200/M)

- Four bedroom detached home
- Re-fitted shower room and bathroom
- Re-fitted kitchen
- Conservatory
- Enclosed rear garden
- Driveway and garage





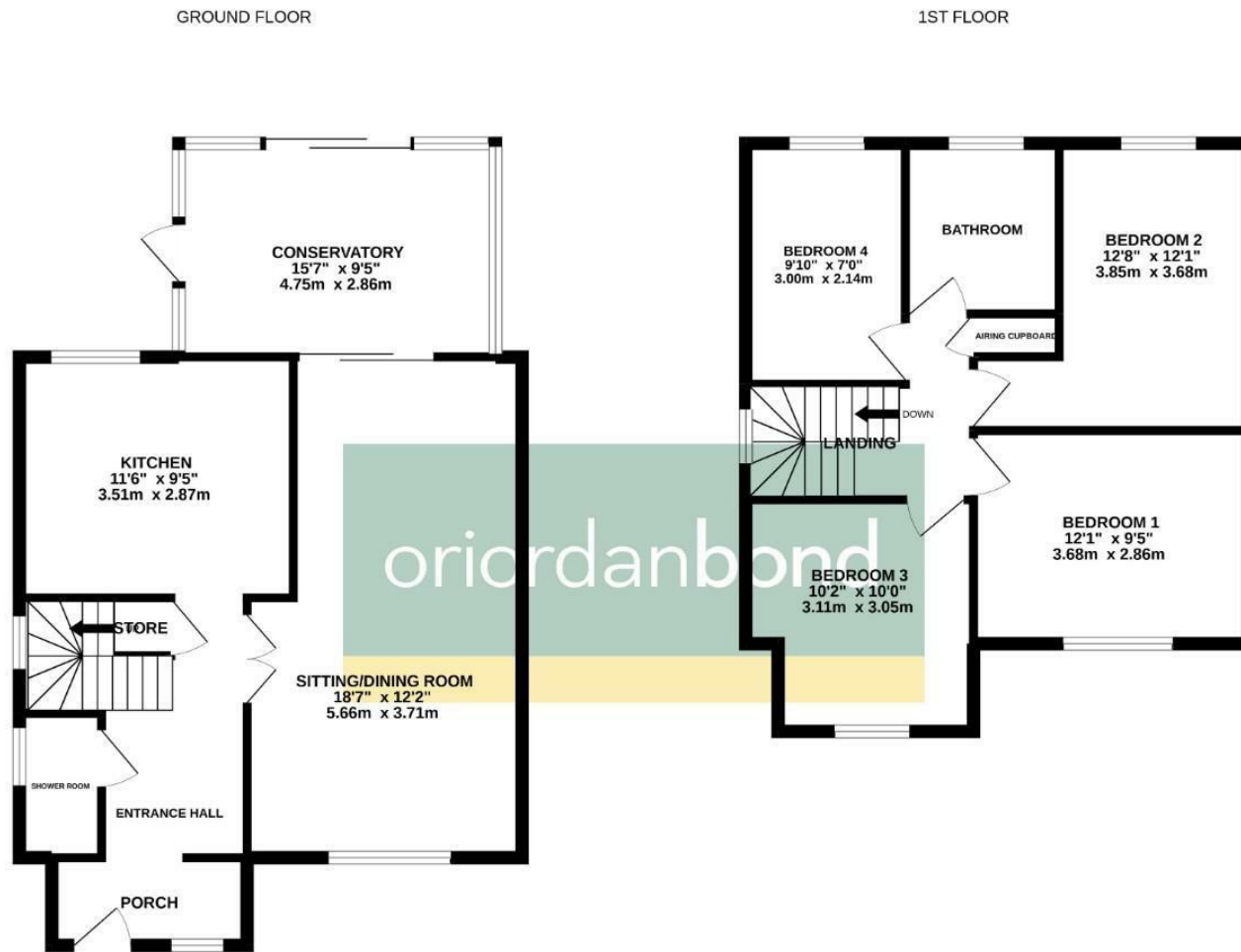

TOTAL FLOOR AREA: 1200sq.ft (111.5 sq.m.) approx.
 Whilst every attempt has been made to ensure the accuracy of the floorplan contained here, measurements of doors, windows, rooms and any other items are approximate and no responsibility is taken for any error, omission or mis-statement. This plan is for illustrative purposes only and should be used as such by any prospective purchaser. The services, systems and appliances shown have not been tested and no guarantee as to their operability or efficiency can be given.
 Made with: Metropix ©2022.

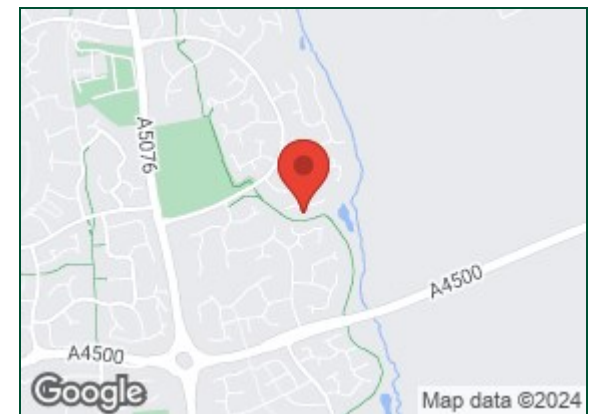

Additional information

- Council Tax Band: D
- Energy Efficiency Rating: D

Viewing

Viewing strictly by appointment – details below

Disclaimer

O’Riordan Bond Estate Agents Limited has not tested apparatus, equipment, fittings or services and so cannot verify they are in working order. The buyer is advised to obtain verification from their solicitor or surveyor.

O’Riordan Bond Weston Favell Sales

01604 784007

westonfavell@oriordanbond.co.uk

