



Adnitt Road

Abington, Northampton

oriordanbond
SALES & LETTINGS



GROUND FLOOR



1ST FLOOR



Adnitt Road

Abington

NN1 4LL

PRICE £220,000

An extremely well presented and larger than average bay fronted two bedroom Victorian terraced property situated close to Abington Park and the Wellingborough Road's vibrant shops, bars and restaurants.

The accommodation comprises entrance hall, sitting room open to dining room with feature wood burner, re-fitted kitchen with some integrated appliances and a re-fitted utility/WC. The first floor offers two double bedrooms and a large re-fitted family bathroom. Outside is an enclosed rear garden with patio area and lawn. Further benefits include uPVC double glazing, gas radiator heating, character features, part converted cellar and available with no onward chain. (A/871/M)

Additional information

- Council Tax Band: B
- Energy Efficiency Rating: D

Viewing

Viewing strictly by appointment – details below

Disclaimer

O'Riordan Bond Estate Agents Limited has not tested apparatus, equipment, fittings or services and so cannot verify they are in working order. The buyer is advised to obtain verification from their solicitor or surveyor.

O'Riordan Bond Abington Sales

01604 639007

abington@oriordanbond.co.uk

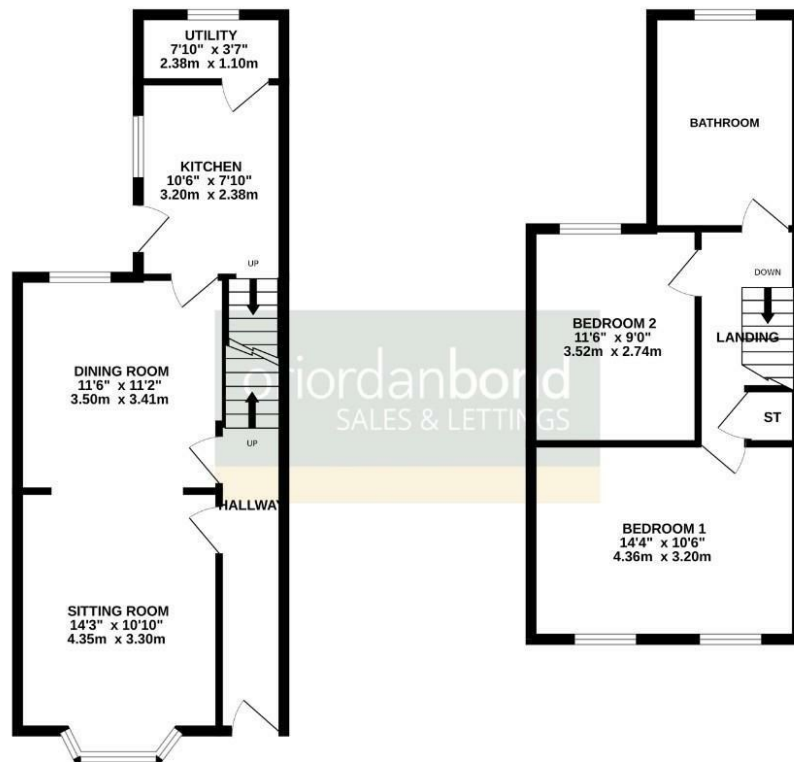

TOTAL FLOOR AREA : 871 sq.ft. (80.9 sq.m.) approx.

Whilst every attempt has been made to ensure the accuracy of the floorplan contained here, measurements of doors, windows, stairs and any other items are approximate and no responsibility is taken for any error, omission or misstatement. This plan is for illustrative purposes only and should be used as such by any prospective purchaser. The services, systems and appliances shown have not been tested and no guarantee as to their operability or efficiency can be given.
Made with floorplan.co.uk

