



# Hazeldene Road

Links View, Northampton

**oriordanbond**  
SALES & LETTINGS





## Hazeldene Road

Links View

NN2 7PA

PRICE £250,000

O'Riordan Bond is pleased to present to the market this double bay fronted three bedroom end terraced property situated within the ever popular Links View. Offered for sale with no onward chain, the property is located near to The Racecourse and Northampton School for Girls.

The accommodation comprises entrance hall, sitting room open to dining room and a re-fitted kitchen with access to a shower room and cloakroom/WC. To the first floor are three good size bedrooms and a family bathroom with separate WC. Outside is a front garden and an enclosed rear garden with lawn and patio areas and an outhouse providing storage. Further benefits include uPVC double glazing and gas radiator heating. (B/1076/M)

### Additional information

- Council Tax Band: C
- Energy Efficiency Rating: D

### Viewing

Viewing strictly by appointment – details below

### Disclaimer

O'Riordan Bond Estate Agents Limited has not tested apparatus, equipment, fittings or services and so cannot verify they are in working order. The buyer is advised to obtain verification from their solicitor or surveyor.

O'Riordan Bond Abington Sales

01604 639007

abington@oriordanbond.co.uk

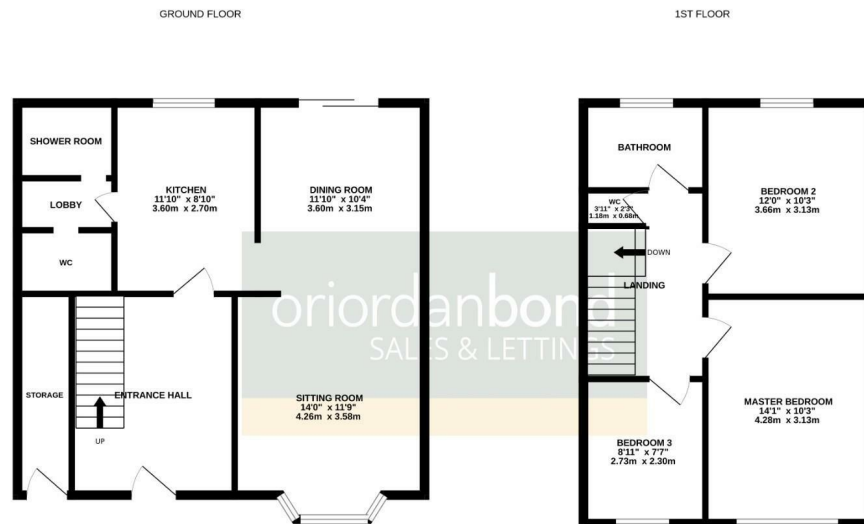

TOTAL FLOOR AREA: 1076 sq.ft. (100.0 sq.m.) approx.  
Whilst every attempt has been made to ensure the accuracy of the floorplan contained here, measurements of doors, windows, rooms and any other items are approximate and no responsibility is taken for any error, omission or mis-statement. This plan is for illustrative purposes only and should be used as such by any prospective purchaser. The services, systems and appliances shown have not been tested and no guarantee as to their operability or efficiency can be given.  
Made with Metreplan CS2025

