



Pytchley Street

Abington, Northampton

oriordanbond
SALES & LETTINGS



FLAT 1



FLAT 2

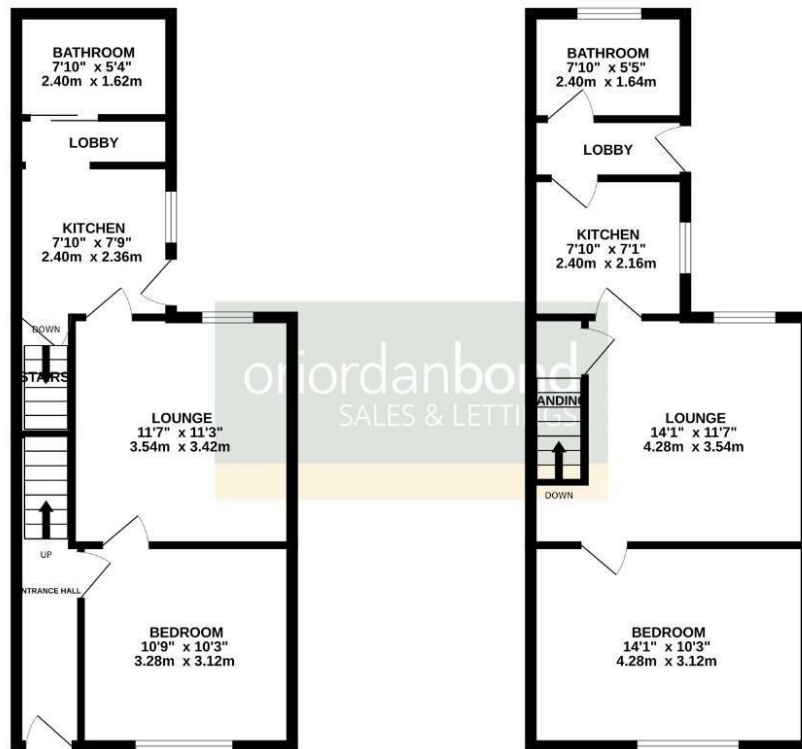

TOTAL FLOOR AREA: 858 sq ft (79.7 sq.m.) approx.
 Whilst every attempt has been made to ensure the accuracy of the floorplan contained here, measurements of doors, windows, rooms and any other items are approximate and no responsibility is taken for any error, omission or mis-statement. This plan is for illustrative purposes only and should be used as such by any prospective purchaser. The services, systems and appliances shown have not been tested and no guarantee as to their operability or efficiency can be given.
 Made with floorplan 10/20/25

Pytchley Street

Abington

NN1 5QY

PRICE £230,000

O'Riordan Bond is delighted to offer an ideal investment opportunity situated in Abington, within short walking distance of Northampton General Hospital and the town centre. The property was historically split into two apartments but is offered for sale as one freehold title.

Available with no onward chain, the accommodation on the ground floor comprises entrance hall, sitting room, kitchen, a double bedroom and a bathroom. The first floor provides entrance hall, sitting room, double bedroom, re-fitted kitchen and a re-fitted bathroom. Outside is small garden which is shared by the two apartments. Further benefits include gas radiator heating, uPVC double glazing, separate gas/electric supplies and separate council tax paid. (B/858/S)

Additional information

- Council Tax Band: A
- Energy Efficiency Rating: D

Viewing

Viewing strictly by appointment – details below

Disclaimer

O'Riordan Bond Estate Agents Limited has not tested apparatus, equipment, fittings or services and so cannot verify they are in working order. The buyer is advised to obtain verification from their solicitor or surveyor.

O'Riordan Bond Abington Sales

01604 639007

abington@oriordanbond.co.uk

