



# Radleigh Court, Homestead Way

Kingsley, Northampton

oriordanbond  
SALES & LETTINGS



GROUND FLOOR  
630 sq.ft. (58.5 sq.m.) approx.

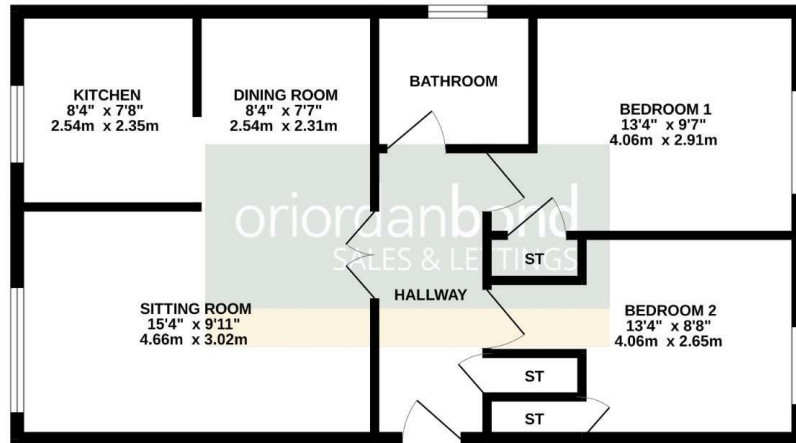

TOTAL FLOOR AREA : 630 sq.ft. (58.5 sq.m.) approx.  
While every attempt has been made to ensure the accuracy of the floorplan contained here, measurements of doors, windows, rooms and any other items are approximate and no responsibility is taken for any error, omission or mis-statement. This plan is for illustrative purposes only and should be used as such by any prospective purchaser. The services, systems and appliances shown have not been tested and no guarantee as to their operability or efficiency can be given.  
Made with Metrcpx ©2024

## Radleigh Court, Homestead Way

Kingsley  
NN2 6JG

PRICE £134,995

A very well presented and much improved two bedroom first floor apartment, situated on this quiet residential street, close to Northampton's Old Racecourse Park.

Accommodation comprises secure entry, spacious entrance hall, sitting room, kitchen/dining room, two double bedrooms and a re-fitted bathroom. Outside is allocated off road parking and a single garage. Further benefits include double glazing and electric heating. (A/630/-)

Leasehold Information: Lease Remaining - 62 years (as of 2024) / Ground Rent - £80 per annum / Service Charge - £1,300 per annum

### Additional information

- Council Tax Band: B
- Energy Efficiency Rating: C

### Viewing

Viewing strictly by appointment – details below

### Disclaimer

O'Riordan Bond Estate Agents Limited has not tested apparatus, equipment, fittings or services and so cannot verify they are in working order. The buyer is advised to obtain verification from their solicitor or surveyor.

O'Riordan Bond Abington Sales  
01604 639007  
abington@oriordanbond.co.uk

