



Celtic Drive, Andover,
£255,000

2 1 1



Situated in a popular area of Andover, is this delightful two bedroom home which offers parking and stunning rear garden. You enter into this home and are greeted by the modern, stylish kitchen. The living/ dining room offers flexible living choices and has patio doors opening onto the garden. To the first floor there are two bedrooms, both with built in storage and a modern bathroom with shower. Externally there is parking for two cars. A particular feature of this home is the landscaped rear garden with seating areas. This home must be viewed to appreciate all that is on offer. Council Tax Band C.



Celtic Drive, Andover, SP10

Approximate Area = 586 sq ft / 54.4 sq m

For identification only - Not to scale



GROUND FLOOR

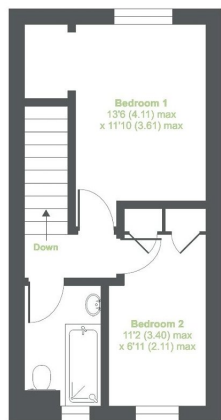

FIRST FLOOR



Floor plan produced in accordance with RICS Property Measurement Standards incorporating International Property Measurement Standards (IPMS Residential). © richvecom 2024. Produced for Brockenhurst Estate Agents. REF: 1132896

