

HUNTERS[®]

HERE TO GET *you* THERE



Fairlands Court, North Park

Eltham, London, SE9 5BH

£1,400 Per Month



Floor Plan

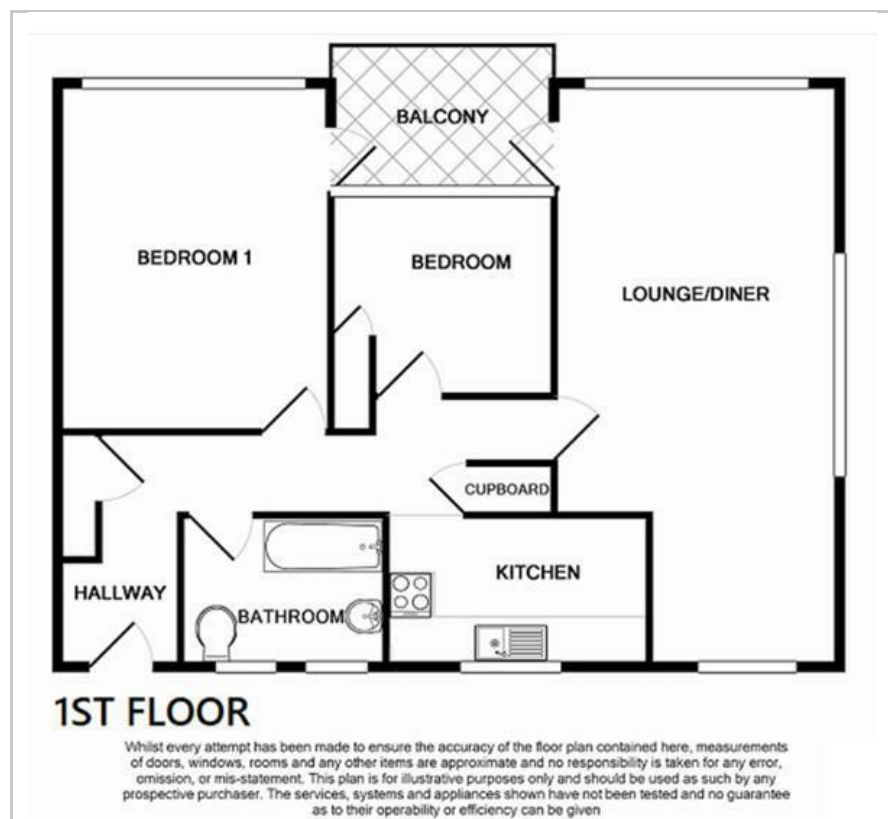

Area Map

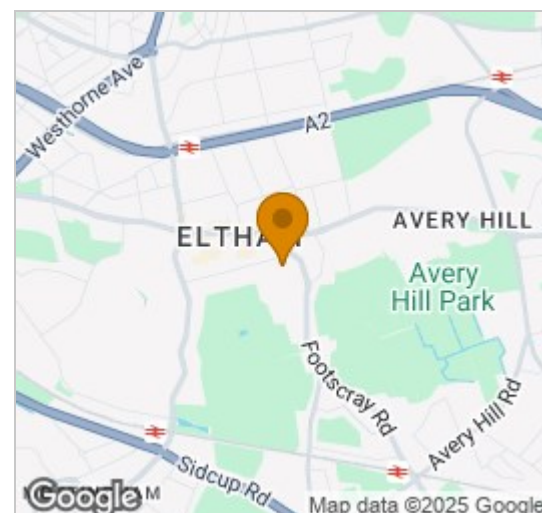

Energy Efficiency Graph

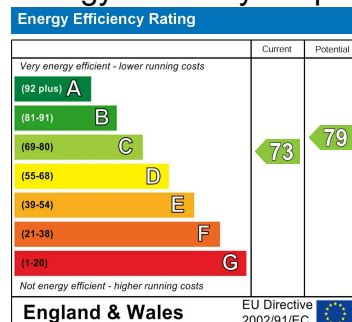

Viewing

Please contact our Hunters Bromley & Chislehurst Office on 020 8464 2555 if you wish to arrange a viewing appointment for this property or require further information.

- Two bedroom apartment
- First floor
- Garage
- Communal entrance hall
- Balcony
- EPC C

Hunters are pleased to offer for rental this spacious 2 bed, 1 bathroom flat with a balcony and garage situated 0.2 miles from Eltham high street with all its amenities. The property is accessed via a communal hallway with stairs leading to the first floor. Internally the property comprises hallway, lounge, kitchen, two bedrooms and a family bathroom. Outside there is parking and a grage. The property is situated 0.9 miles from Eltham station and 1.1 mile from Mottingham station. EPC C



These particulars are intended to give a fair and reliable description of the property but no responsibility for any inaccuracy or error can be accepted and do not constitute an offer or contract. We have not tested any services or appliances (including central heating if fitted) referred to in these particulars and the purchasers are advised to satisfy themselves as to the working order and condition. If a property is unoccupied at any time there may be reconnection charges for any switched off/disconnected or drained services or appliances - All measurements are approximate. **THINKING OF SELLING?** If you are thinking of selling your home or just curious to discover the value of your property, Hunters would be pleased to provide free, no obligation sales and marketing advice. Even if your home is outside the area covered by our local offices we can arrange a Market Appraisal through our national network of Hunters estate agents.