



School Lane
Fulford, York
YO10 4LS

£900,000



A stunning four bedroom detached home located in the popular residential area of Fulford, positioned to the south of York. This beautiful home offers over 2,000 sqft of living accommodation and is set on a wonderful plot offering a generous rear garden and a gated driveway to the front with a double garage. Set back from Heslington Lane, this property is within walking distance of the independent amenities Fulford Main Street has to offer, and is ideally placed for Fulford Secondary School.

Internally the property comprises a bright and welcoming entrance hall with stairs leading up to the galleried landing on the first floor. The true hub of the home is the principal reception room which is located at the rear of the property. Offering both a snug living room and a generous garden room to the very rear, this space is ideal for any family to enjoy all year round. The contemporary kitchen is located next door and offers plenty of storage by way of shaker style wall and base units, all of which are complimented by quartz worktops. The central island offers more space along with the option for more casual dining. Conveniently there is a utility room and w.c off the kitchen. The ground floor accommodation is completed by two further reception rooms, currently used as a dining room and study.

Upstairs and onto the galleried landing, the master bedroom is located to the front of the property and offers a striking vaulted ceiling. Off this generous bedroom is a shower ensuite and storage area. Three further bedrooms are on this floor, with the main guest room also enjoying a contemporary ensuite, along with a three piece family bathroom.

Set on a generous plot, this home offers a beautiful rear garden which consists of lawn, patio and flower bed areas. An expansive gated driveway is to the front of the property offering parking for multiple vehicles in addition to the double garage.





School Lane Fulford, York YO10 4LS

Freehold
Council Tax Band - G

- Detached Home
- Four Bedrooms
- Three Reception Rooms
- Double Garage & Gated Driveway
- West Facing Garden
- Beautifully Presented Throughout
- Sought After Area
- Epc C

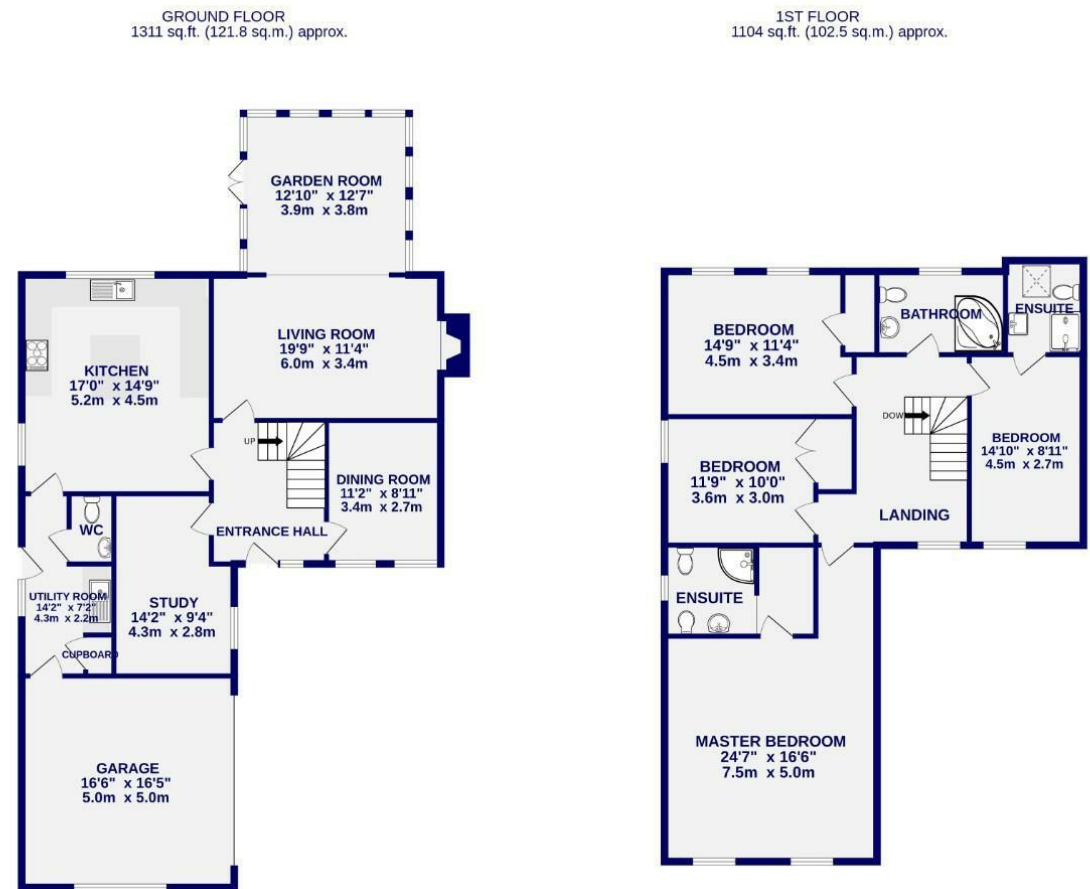

TOTAL FLOOR AREA: 2414 sq.ft. (224.3 sq.m.) approx.

Whilst every attempt has been made to ensure the accuracy of the floorplan contained here, measurements of doors, windows, rooms and any other items are approximate and no responsibility is taken for any error, omission or mis-statement. This plan is for illustrative purposes only and should be used as such by any prospective purchaser. The services, systems and appliances shown have not been tested and no guarantee as to their operability or efficiency can be given.
Made with Metropix ©2023

These particulars have been prepared as accurately and as reliably as possible, but should not be relied upon as 'statement of fact'. If there is any point which is of particular importance to you, please contact the office and we would be pleased to check the information. We have not tested any services, appliances, equipment or facilities and nothing in these particulars should be deemed to be a statement that they are in good working order, or that the property is in good structural condition or otherwise. Any areas, measurements, floor plans or distances referred to are given as a guide only and are not precise. Purchasers must satisfy themselves by inspection or by otherwise regarding the items mentioned above and as to the correctness of each of the statements contained in these particulars. No person in the employment of Ashtons has any authority to make or give any representation or warranty whatsoever in relation to this property or these particulars nor enter into any contract relating to the property on behalf of the vendor.