

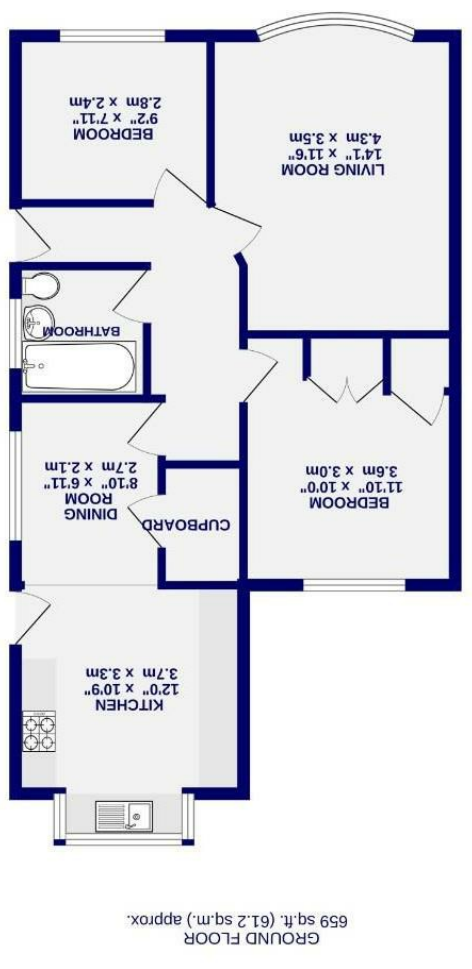

Beech Glade Huntington, York YO31 9EP

Freehold
Council Tax Band - C

- Semi Detached Bungalow
- Two Double Bedrooms
- Extended Dining Kitchen
- Modern Family Bathroom
- Detached Garage & Driveway
- West Facing Rear Garden
- EPC C



Beech Glade
Huntington, York
YO31 9EP

£290,000

 2  1

Located in a quiet cul-de-sac in ever-popular Huntington, this spacious and well-maintained two bedroom semi-detached bungalow is offered with no onward chain. Just off New Lane, the property enjoys easy access to local shops and amenities, excellent bus routes into York city centre, and the retail and leisure facilities at Monks Cross and Vangarde.

Internally, the accommodation has been thoughtfully arranged and is well presented throughout. A bright entrance hall leads through to the main lounge, a generous space with a bay window and feature fireplace. Two well-proportioned double bedrooms sit alongside a modern three-piece bathroom. The original third bedroom has been opened up to create a large dining kitchen – a fantastic space for everyday living or entertaining – fitted with contemporary slate grey units and a range of integrated appliances.

Externally, the property sits on a generous plot with low-maintenance gardens to the front and rear. A long driveway offers ample off-street parking and leads to a detached single garage. The rear garden is fully enclosed, enjoying a lawn, patio seating area, and raised borders.

A fantastic opportunity in a prime residential location – early viewing is recommended.

Council Tax Band- C

