

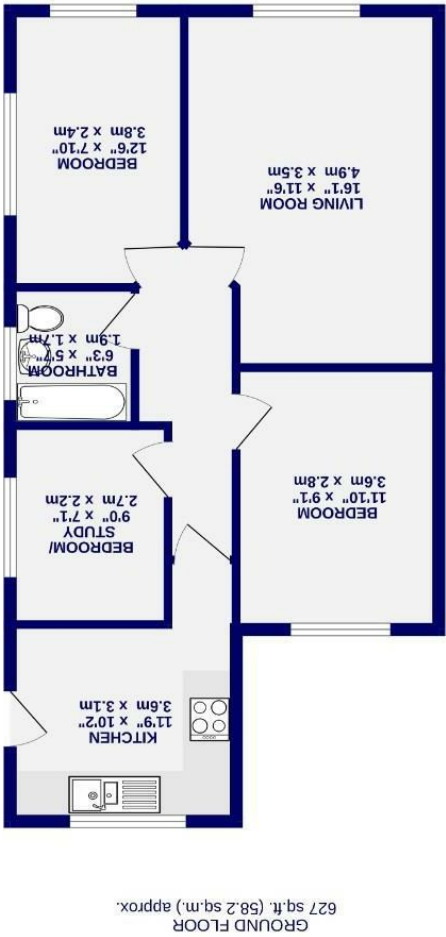

# Gorse Paddock Huntington, York YO31 9EW

Freehold  
Council Tax Band - C

- Semi Detached Bungalow
- Three Bedrooms
- Modern Throughout
- Garage & Driveway
- Front & Rear Garden
- Popular Residential Area
- Expected To Be Popular
- EPC C



These particulars have been prepared as accurately and as reliably as possible, but should not be relied upon as 'statement of fact'. If there is any point which is of particular importance to you, please contact the office and we would be pleased to check the information. We have not tested any services, appliances, equipment or facilities and nothing in these particulars should be deemed to be a statement that they are in good working order, or that the property is in good structural condition or otherwise. Any areas, measurements, floor plans or distances referred to are given as a guide only and are not precise. Purchasers must satisfy themselves by inspection or by otherwise regarding the items mentioned above and as to the correctness of each of the statements contained in these particulars. No person in the employment of Ashtons has any authority to make or give any representation or warranty whatsoever in relation to this property or these particulars nor enter into any contract relating to the property on behalf of the vendor.



Gorse Paddock  
Huntington, York  
YO31 9EW

Offers Over £280,000

 3  1

Located in the popular residential area of Huntington, this well-presented semi-detached bungalow is ready to move into and would make a wonderful first home or ideal downsize. Positioned to the north of York, Huntington offers excellent commuter links to York city centre and train station, as well as convenient access to Monks Cross shopping centre and Vanguard.

Internally, the property features a fitted kitchen comprising a range of wall and base units, all complemented by stylish worktops and splashbacks. At the front of the property, the spacious reception room boasts a large bay window, allowing plenty of natural light and providing views of the front aspect. The bungalow also includes three well-proportioned bedrooms and a modern three-piece bathroom.

To the rear, the property benefits from a well-maintained, enclosed garden. Generous in size, the outdoor space offers a combination of patio, lawn, and gravel areas, creating a low-maintenance garden ideal for relaxing or entertaining. At the front, there is an additional garden and a driveway that leads to a single garage at the rear, providing ample off-street parking.

Overall, this delightful property is sure to appeal to a variety of buyers. Early viewing is highly recommended.

Council Tax Band- C

