

These particulars have been prepared as accurately and as reliably as possible, but should not be relied upon as 'statement of fact'. If there is any point which is of particular importance to you, please contact the office and we would be pleased to check the information. We have not tested any services, appliances, equipment or facilities and nothing in these particulars should be deemed to be a statement that they are in good working order, or that the property is in good structural condition or otherwise. Any areas, measurements, floor plans or distances referred to are given as a guide only and are not precise. Purchasers must satisfy themselves by inspection or by otherwise regarding the items mentioned above and as to the correctness of each of the statements contained in these particulars. No person in the employment of Ashtons has any authority to make or give any representation or warranty whatsoever in relation to this property or these particulars nor enter into any contract relating to the property on behalf of the vendor.

# Main Street Askham Bryan, York YO23 3QS

Freehold  
Council Tax Band - E

- Detached Bungalow
- Three Double Bedrooms
- Large Living / Dining Room
- Two Bathrooms
- Kitchen/ Separate Utility
- Large Plot
- EPC D

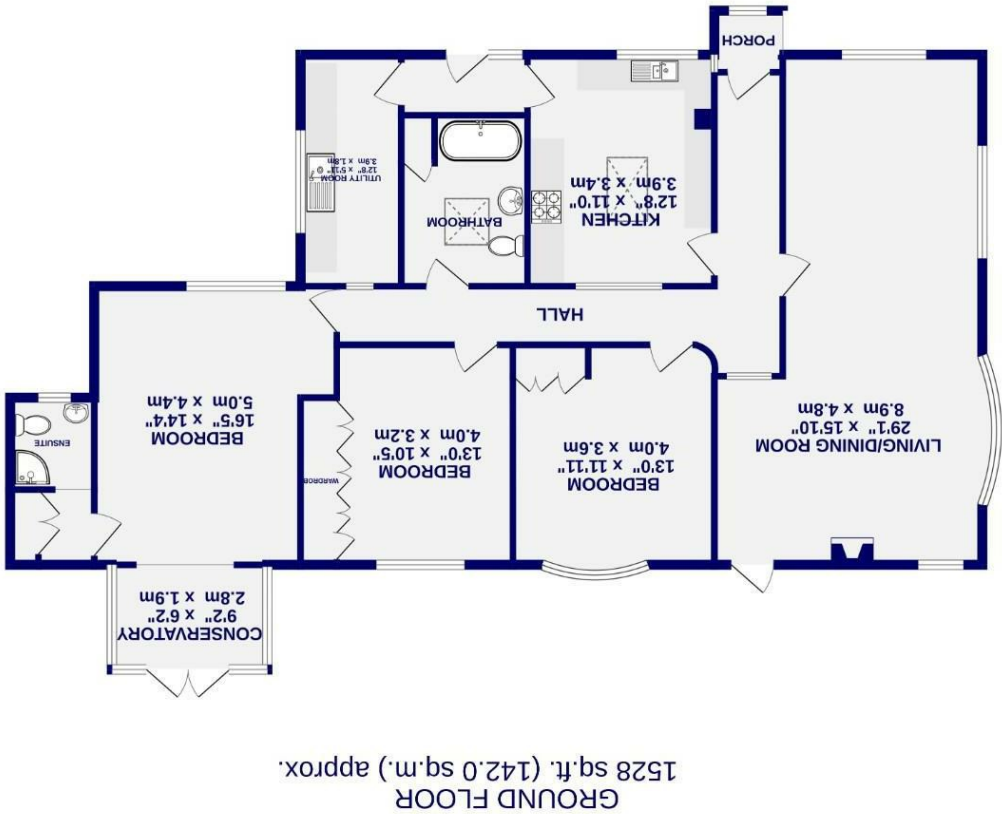



Main Street  
Askham Bryan, York  
YO23 3QS

Offers Over £575,000

3 2

A beautifully presented three-bedroom detached bungalow, nestled in the peaceful and highly sought-after village of Askham Bryan, to the south of York. Occupying a private plot on the village's main street, the property enjoys a tranquil setting, screened by tall hedge boundaries for added privacy. A much-loved home for many years, it has been meticulously maintained and thoughtfully extended by the current owners.

Upon entering, is a spacious entrance hall that sets the tone for the generous accommodation on offer. To the left is a stunning open-plan living area, flooded with natural light from windows across three aspects. This warm, inviting space is enhanced by characterful features including a wood-burning stove, solid oak flooring, and an exposed ceiling beam, creating a perfect blend of comfort and rustic charm.

Across the hall is a well-appointed kitchen, fitted with NEFF appliances and a range of solid wood wall and base units, complemented by light worktops that reflect the sunlight pouring in from a skylight above. As part of a considered extension, a separate utility room has been added, providing further storage and housing additional white goods.

The internal hallway leads to three generously sized bedrooms, one of which is currently used as a home office or study. The family bathroom is immaculately presented and brightened by another skylight, while the principal bedroom benefits from its own en-suite and a conservatory extension, offering panoramic views of the beautifully landscaped gardens. Integrated storage further adds to the home's practical appeal.

