

- Two Bedrooms
- Popular Location
- On Street Parking
- Close to River Walks and Parks

- Open Plan Living Kitchen
- Tucked Away
- Access to the City Centre
- EPC - D

Ashtons Estate Agents is pleased to offer this charming two-bedroom traditional terrace, tucked away in a popular residential area just off Leeman Road. Ideally positioned within easy reach of York city centre, the railway station, and a variety of local amenities, the property also benefits from lovely riverside walks nearby and excellent transport links for commuting across the city and beyond.

The accommodation comprises a bright and airy open-plan living and dining space, tastefully separated by a sleek and modern breakfast bar. The kitchen features a range of cream gloss wall and base units, providing ample storage, while the wooden worktops offer plenty of space for food preparation and casual dining. Off the kitchen is a handy utility area with access to the sunny, walled courtyard, perfect for enjoying a morning coffee or relaxing in the sunshine. From the utility, a modern bathroom with a white suite completes the ground floor.

To the first floor are two generously sized double bedrooms, each with large windows allowing natural light to flood in, creating a sense of calm and comfort.

In summary, this delightful two-bedroom terrace is situated in a well-connected and desirable part of York and is sure to appeal to a wide range of buyers. It represents an ideal first-time purchase, offering a move-in-ready home with charm, character, and excellent convenience. Early viewing is essential to appreciate the space, setting, and potential on offer.

Council Tax Band: A

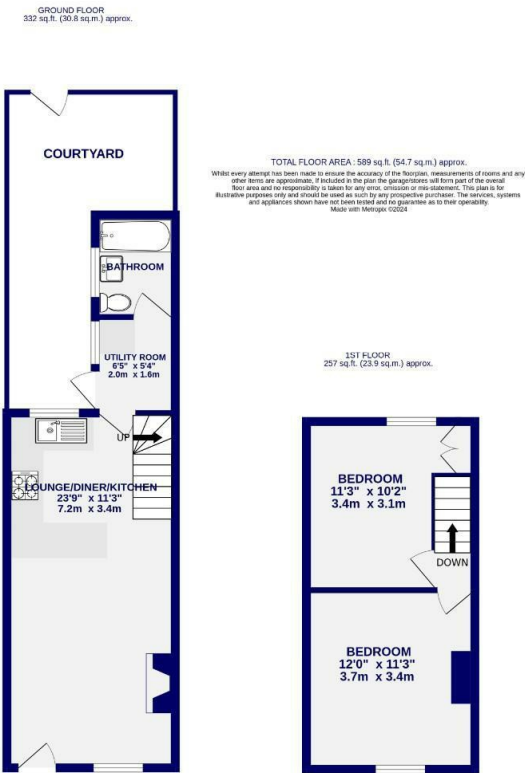

These particulars have been prepared as accurately and as reliably as possible, but should not be relied upon as 'statement of fact'. If there is any point which is of particular importance to you, please contact the office and we would be pleased to check the information. We have not tested any services, appliances, equipment or facilities and nothing in these particulars should be deemed to be a statement that they are in good working order, or that the property is in good structural condition or otherwise. Any areas, measurements, floor plans or distances referred to are given as a guide only and are not precise. Purchasers must satisfy themselves by inspection or by otherwise regarding the items mentioned above and as to the correctness of each of the statements contained in these particulars. No person in the employment of Ashtons has any authority to make or give any representation or warranty whatsoever in relation to this property or these particulars nor enter into any contract relating to the property on behalf of the vendor.