

- EPC - C

- Ground Floor Apartment
- One Bedrooms
- Fitted Bedroom Storage
- South Facing Aspect
- Popular Over 60's Development
- Near Social Communal Spaces
- Offered With No Onward Chain

Leasehold  
Council Tax Band - A

The Village,  
York  
YO32 2HY

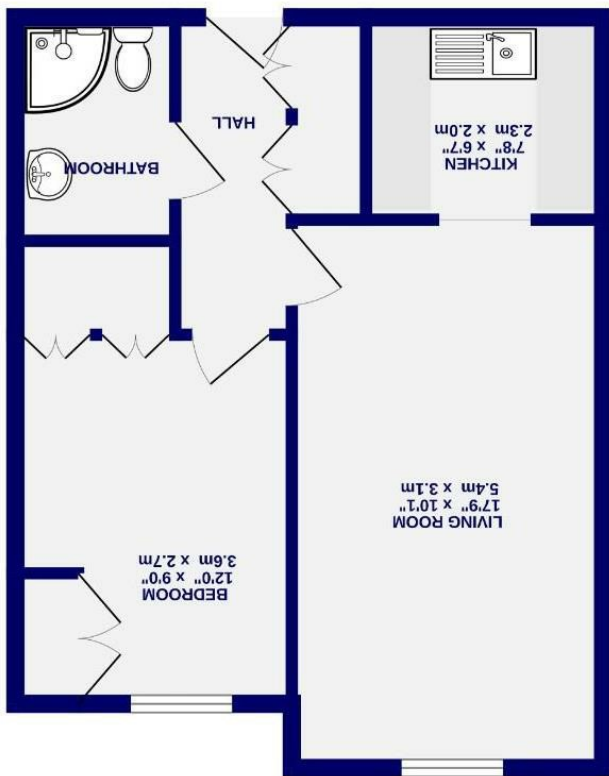



The Village  
, York  
YO32 2HY

£112,000



A rare opportunity to acquire a one bedroom apartment in this popular 'Over 60's' development, Ashgrove is situated within The Village, Haxby. Within walking distance to a variety of local amenities, such as Sainsbury's, GP's, dentists and bus commuter links to York city centre, this property is ideally placed and is offered with no onward chain.

Positioned on the ground floor and within easy reach of the social communal areas, this apartment comprises; an entrance hallway with storage cupboard, a spacious reception area which leads through to the generous kitchen. Fitted with multiple wall and base units, the kitchen offers plenty of storage and worktop space, along with some space for additional white goods. The rest of the property offers one double bedroom, fitted with built in storage, and an updated shower room with the added benefit of new electric heaters, shower unit, water heating system and fuse board.

Ashgrove offers a variety of communal areas within the development, including a laundry room, storage rooms, community lounge and community kitchen. It is part warden controlled for added convenience for the residents. Depending on availability, there is the option to reserve a permanent parking space when purchasing the property.

Offered with no onward chain, viewing is highly recommended.

Leasehold  
Length of lease- 125 years from 1 August 1987  
Ground rent £30 per annum  
Service charge £3,500 per annum

Council Tax Band - A

