

These particulars have been prepared as accurately and as reliably as possible, but should not be relied upon as 'statement of fact'. If there is any point which is of particular importance to you, please contact the office and we would be pleased to check the information. We have not tested any services, appliances, equipment or facilities and nothing in these particulars should be deemed to be a statement that they are in good working order, or that the property is in good structural condition or otherwise. Any areas, measurements, floor plans or distances referred to are given as a guide only and are not precise. Purchasers must satisfy themselves by inspection or by otherwise regarding the items mentioned above and as to the correctness of each of the statements contained in these particulars. No person in the employment of Ashtons has any authority to make or give any representation or warranty whatsoever in relation to this property or these particulars nor enter into any contract relating to the property on behalf of the vendor.

- Semi Detached Bungalow
- South Facing Garden
- Garage & Driveway
- No Onward Chain
- In Need Of Modernisation
- Two Bedrooms
- EPC - D

Freehold
Council Tax Band - C

Eastlands Avenue Holgate, York YO24 4NZ

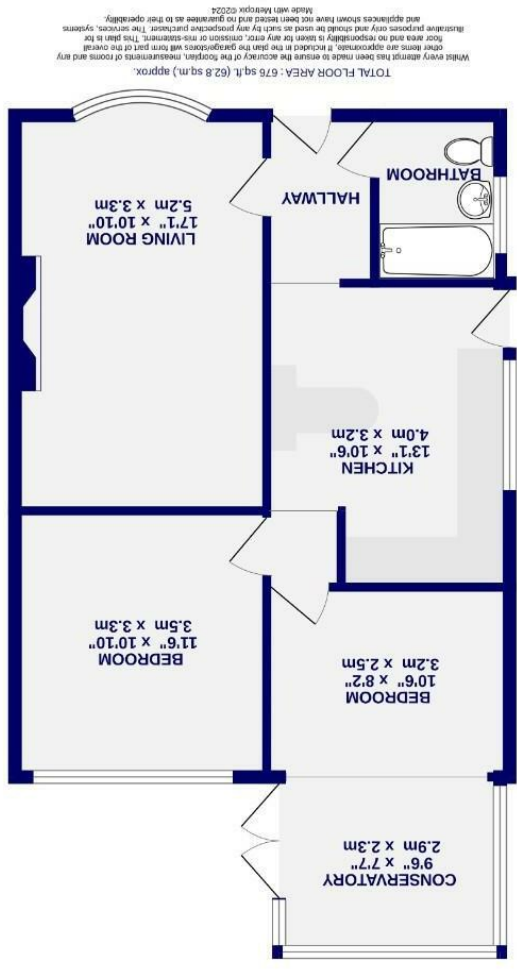

GROUND FLOOR
676 sq. ft. (62.8 sq.m.) approx.



Eastlands Avenue
Holgate, York
YO24 4NZ

£220,000



A two bedroom semi detached bungalow positioned in a quiet cul de sac, in need of modernisation.

Located in Eastlands Avenue in a lovely development of bungalows positioned to the north of Hob Moor Nature Reserve. The area benefits from a range of local amenities offered by its proximity to Holgate, Acomb and Dringhouses. This most notably includes West Bank Park, Hob Moor and Acomb Front Street shops.

The accommodation in brief; a front hallway leads to a three piece family bathroom and a large living/ dining room with bay window. To the rear a breakfast kitchen with central breakfast and white shaker units. To the rear are two double bedrooms and a conservatory with French doors onto the rear garden.

Externally the property benefits from a large front garden and a south facing rear garden with a garage and driveway.

Council Tax Band- C

