

These particulars have been prepared as accurately and as reliably as possible, but should not be relied upon as 'statement of fact'. If there is any point which is of particular importance to you, please contact the office and we would be pleased to check the information. We have not tested any services, appliances, equipment or facilities and nothing in these particulars should be deemed to be a statement that they are in good working order, or that the property is in good structural condition or otherwise. Any areas, measurements, floor plans or distances referred to are given as a guide only and are not precise. Purchasers must satisfy themselves by inspection or by otherwise regarding the items mentioned above and as to the correctness of each of the statements contained in these particulars. No person in the employment of Ashtons has any authority to make or give any representation or warranty whatsoever in relation to this property or these particulars nor enter into any contract relating to the property on behalf of the vendor.

- NO CHAIN
- EPC D
- Walking Distance to City Centre
- Off Street Parking
- 70% Shared Ownership
- Two Bedrooms
- Semi Detached Bungalow

Leasehold
Council Tax Band - C

Bonington Court Off Poppleton Road, YO26 4QN

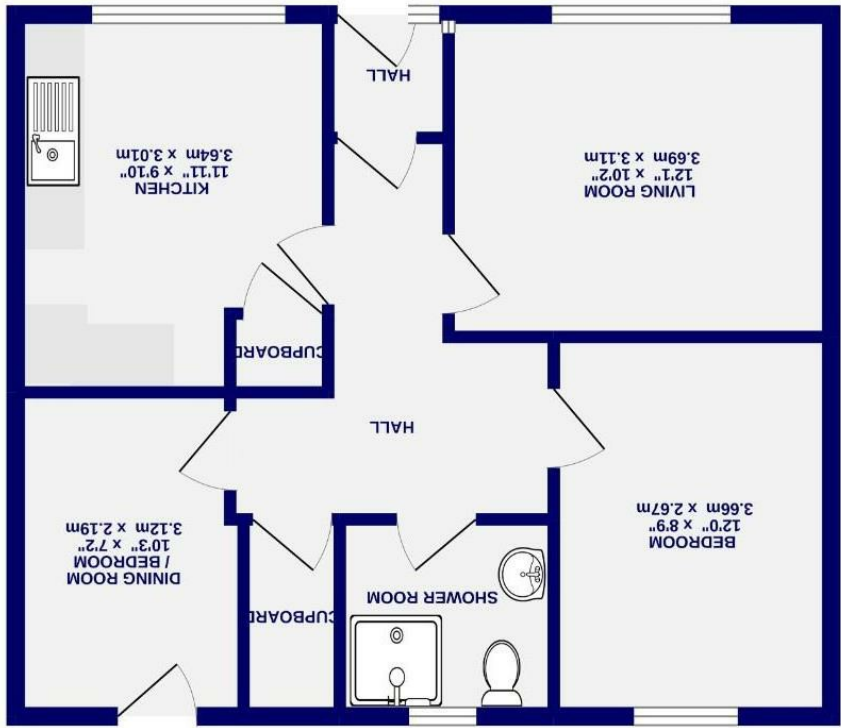

Bonington Court
Off Poppleton Road, York
YO26 4QN

70% Shared ownership
£160 000

 2  1

A rare opportunity to purchase a semi detached bungalow under the Shared Ownership Scheme. This two bedroom home is perfectly situated for easy access to York city centre via local transport links and Acomb's amenities.

The property comprises a wide entrance hallway, generous reception room and kitchen along with two double bedrooms and a large wet room. The property has been updated to a degree but final touches have been left for the new owner, allowing whoever purchases the property the opportunity to make it their own.

Externally the property has a driveway for one vehicle, surrounded by lawned gardens. On street parking is also available. To the rear is a low maintenance patioed courtyard with a shed for additional storage.

Offered with no chain, viewing is highly recommended.

Leasehold
Lease 99 years with 77 years remaining, started 8/9/2000
Rent is £216.63 per month
Reviewed annually on the 1st January
Ground rent nil
Service charge nil
Shared ownership 70% being sold
Council Tax Band C

