



Brookmead Avenue | Bromley

£1,800 pcm

** NO TENANT FEES** 5 bedroom semi detached house on Petts Wood/Bickley border. Briefly comprising 2 good sized reception rooms, modern kitchen, utility room & 5th bedroom/study on ground floor. Upstairs there are 4 bedrooms - 3 doubles & 1 single. Offered unfurnished. Available late NOV Council tax Band F. EPC Rating D



GROUND FLOOR
APPROX. FLOOR
AREA 711 SQ.FT.
(66.1 SQ.M.)

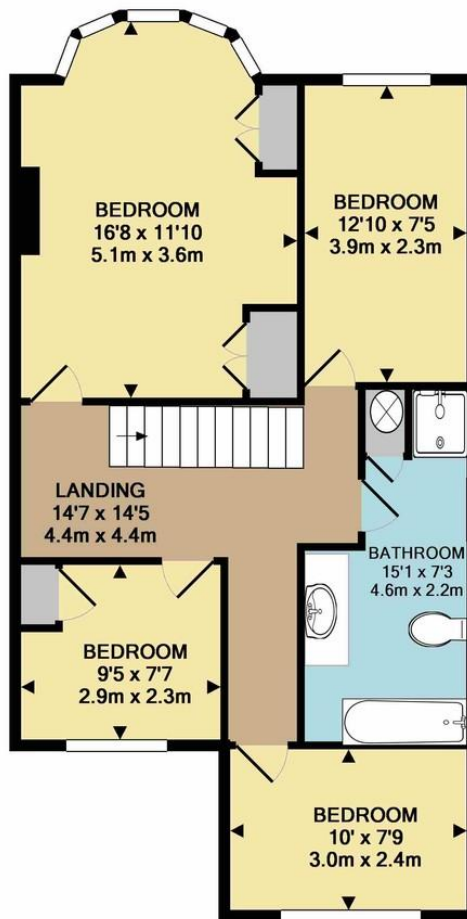

1ST FLOOR
APPROX. FLOOR
AREA 626 SQ.FT.
(58.2 SQ.M.)

TOTAL APPROX. FLOOR AREA 1337 SQ.FT. (124.2 SQ.M.)

Whilst every attempt has been made to ensure the accuracy of the floor plan contained here, measurements of doors, windows, rooms and any other items are approximate and no responsibility is taken for any error, omission, or mis-statement. This plan is for illustrative purposes only and should be used as such by any prospective purchaser. The services, systems and appliances shown have not been tested and no guarantee as to their operability or efficiency can be given
Made with Metropix ©2018

Contact Details

36 Station Square
Petts Wood
Orpington
Kent
BR5 1NA

www.jdmestateagents.com

lettings@jdmlettings.com

01689 838040

Please refer to our website to see our full Area Guides.



Energy Efficiency Rating

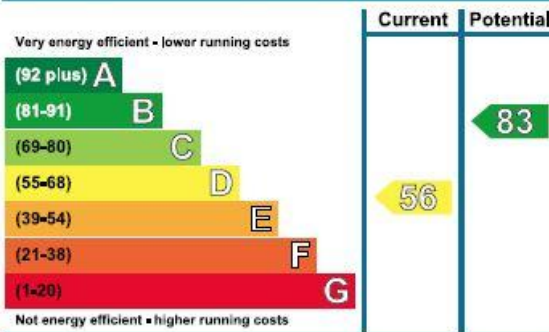

IMPORTANT NOTICE: Every effort has been made to ensure the accuracy of these details however they form no part of any contract and are issued without responsibility on the part of the agents or landlord. Any intending tenant should satisfy themselves by inspection as to the correctness of each statement. Photographs may show only certain parts and aspects of the property at the time when the photographs were taken. We recommend that all information provided is verified by yourselves on inspection.